

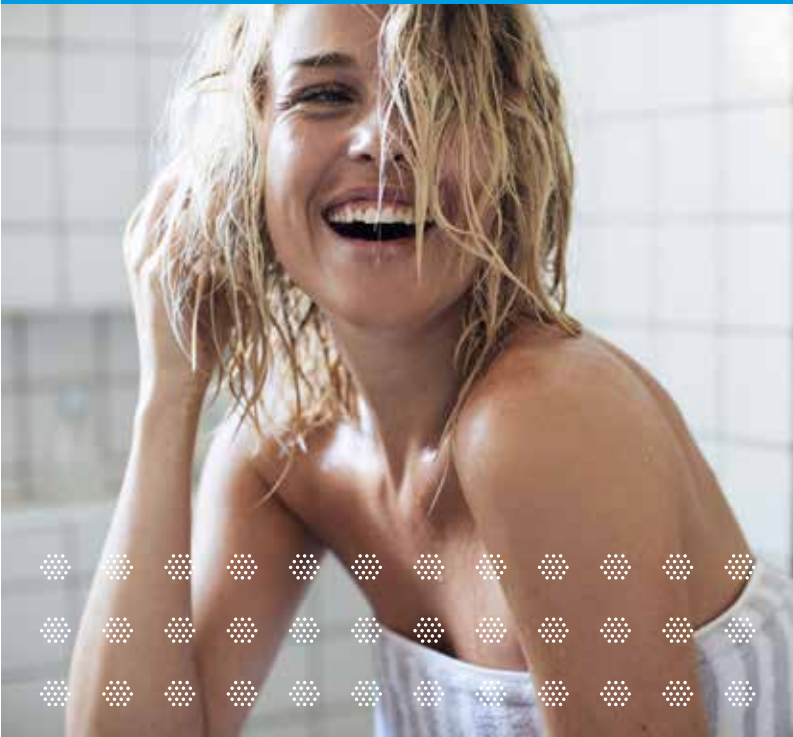

Poresta®
Product Catalog
No. 06



Sanitary engineering. Simple. Smart.



Smart. Intelligent. Sanitary engineering.

Contents

Poresta® floor-level shower systems

2	Design options	30	Technical information: Poresta® BF/BF KMK
26	Product benefits	32	Technical information: Poresta® BF 95
		34	Technical information: Poresta® BF 70
		36	Technical information: Poresta® Limit S
		38	Technical information: Poresta® Limit S 95
		40	Technical information: Poresta® BFR 75
		42	Technical information: Poresta® Slot
		44	Technical information: Poresta® Slot S
		46	Technical information: Poresta® Plus Ge
		48	Technical information: Poresta® Loft
		50	Technical information: Poresta® Loft S

Poresta® bathtub installation systems

52	Design options	70	Ferroplast® 1200 and 2000 mounting frames
60	Product benefits	72	Overview Ferroplast® bathtub base systems
61	Overview: Poresta® shower tray supports	73	Overview Ferroplast® shower tray base systems
62	Overview: Poresta® bathtub supports	74	Mounting accessories for Ferroplast® bathtub base systems
64	Mounting accessories Poresta® tub supports	75	Tub rim mounting for Ferroplast® tub base systems
66	Design accessories Poresta® tub supports	76	Poresta® Universal rectangular apron
68	Mounting accessories for Poresta® bathtub support frame	78	Installation examples Ferroplast® tub base systems and Poresta® Universal rectangular apron

Poresta® floor-level shower systems

2



Poresta® BF/BF KMK



Poresta® BF 95

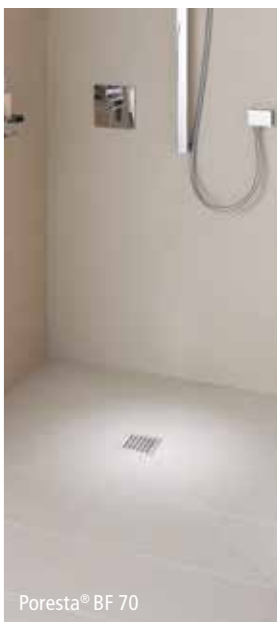

Poresta® BF 70



Poresta® Loft



Poresta® Limit S 95



Poresta® BFR 75



Poresta® Slot



Poresta® Slot S



Poresta® Plus Ge



Poresta® Limit S



Poresta® Loft S

Floor-level shower systems

3

[Design options](#)
Page 2–25

[Product benefits](#)
Page 26–29

[Technology](#)
Page 30–51

Poresta® BF/BF KMK

Classic design for flat-to-the-floor convenience



The Poresta® BF/BF KMK floor-level shower system has been tried and tested **for more than a decade**. This shower solution is available in various sizes and shapes. It can be tiled with different materials to fit perfectly and add new space to the bathroom environment.



Poresta® ready-to-tile drain cover

The barrier-free version of the floor-level shower is an option. Bathroom solutions for people with special needs can be individually designed and installed.

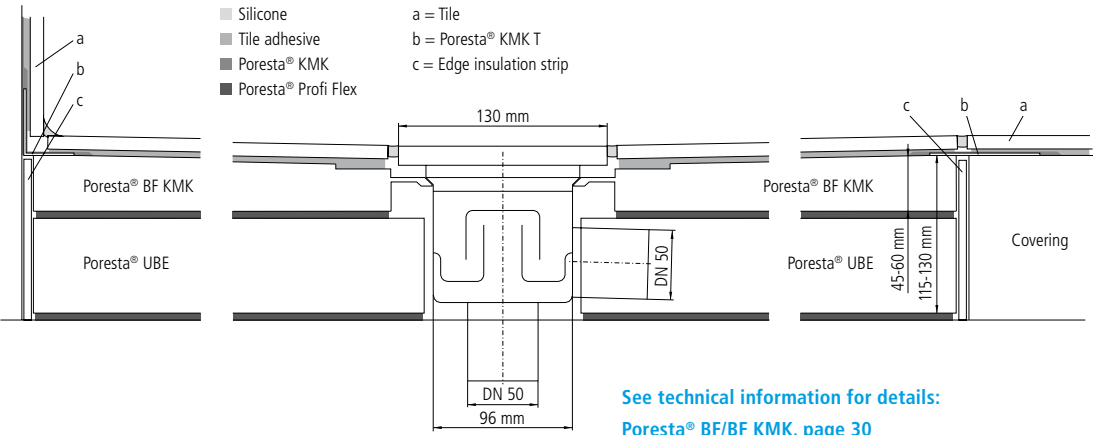

See technical information for details:
Poresta® BF/BF KMK, page 30

Poresta® BF 95

Floor-level showers with reduced height

Poresta® BF 95 combines all the design benefits of a ready-to-tile floor-level shower system with a reduced installation height of only **95 mm**. The standard-compliant water trap height of 50 mm means that the drain can be connected with a standard DN 50 pipe. The shower system is available in various sizes and shapes and can be tiled with many different materials.

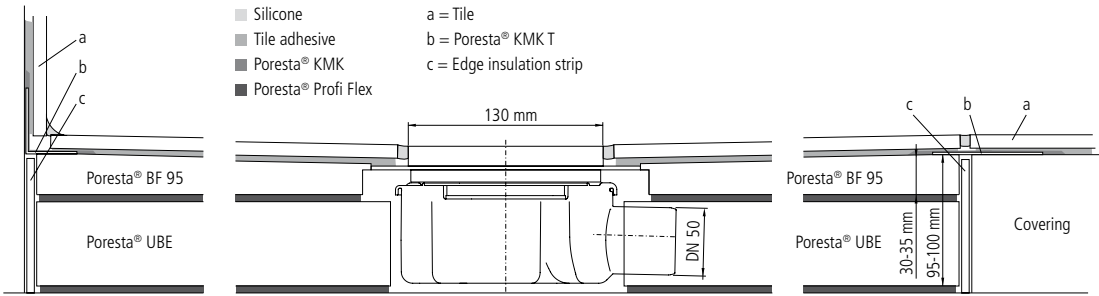
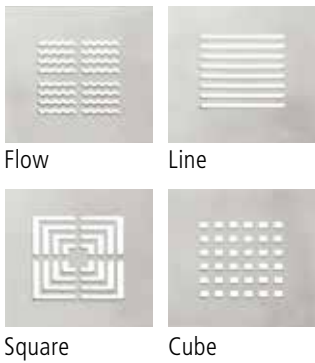

See technical information for details: Poresta® BF 95, page 32

Poresta® BF 70

Creative shower system design for renovation work



Poresta® BF 70 is an ideal choice for bathroom renovations. This floor-level shower system is only **70 mm** high (including gradient) with a standard-compliant DN 50 connection. Poresta® BF 70 can be tiled with materials in all different sizes, shapes and colours. Flat-to-the-floor convenience adds new space in small or older baths.

See technical information for details: [Poresta® BF 70](#) page 34

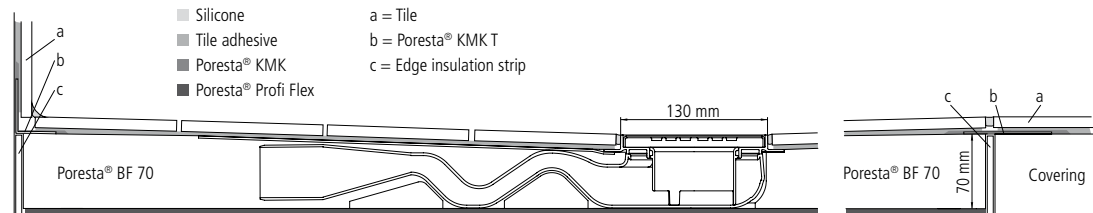

Poresta® Limit S

Elegant design combined with floor-level shower convenience

10



The Poresta® Limit S shower system adds an attractive touch to the modern bathroom. A choice of drain grate designs in high-grade stainless steel opens a new dimension in shower space elegance.

The shower element can be tiled with many different materials in a variety of shapes and colours. A single-sided gradient makes it easier to use larger tiles without sectioning.

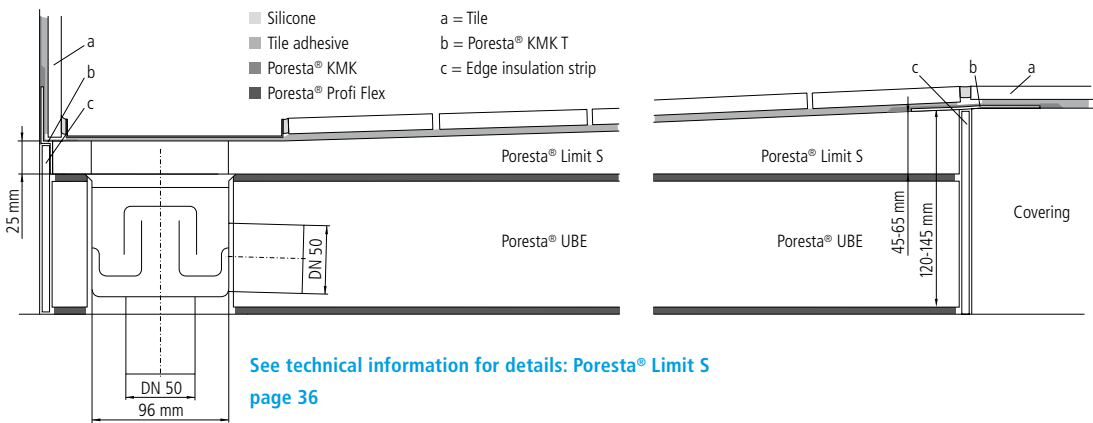

Floor-level shower systems

11



Design C

Design D

Design E

Poresta® Limit S 95

Elegant drain channel design –
also suitable for renovations

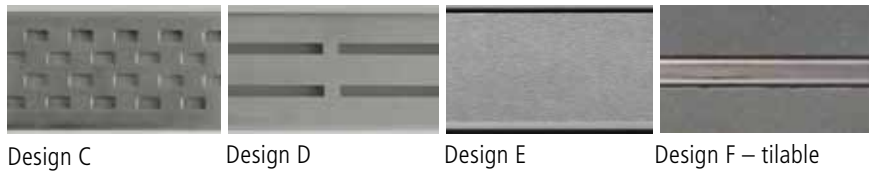

The Poresta® Limit S 95 is a floor-level shower system with an elegant drain channel and a particularly low installation height. As a result, it can equally be used in renovations and new buildings.

Thanks to a tilable grate insert, the shower area can be integrated into the bathroom even more subtly. With its single-sided gradient, the Poresta® Limit S 95 is particularly suitable for larger tile formats. The system meets all the design requirements for modern showers, combining them with innovative, proven technology.

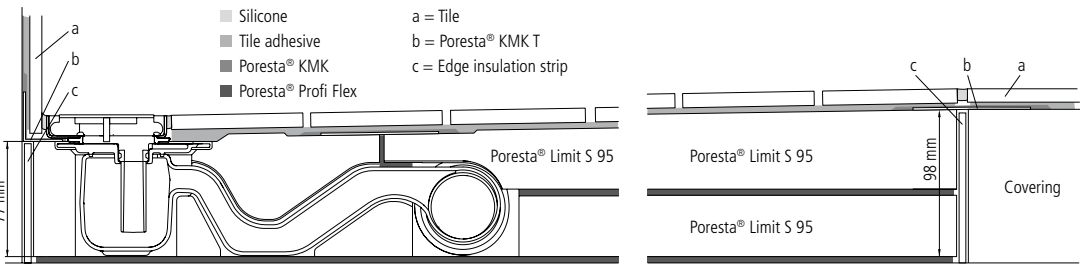

See technical information for details: [Poresta® Limit S](#)
page 38

Poresta® BFR 75

A shower system for all drains –
ideal for renovations

14



And for selected
Shower drains.



The Poresta® BFR 75 shower system can be easily and safely installed in combination with standard shower drains from a variety of manufacturers. The surface can be tiled with different materials – including large-dimension tiles without gradient sectioning. With an installation height of only 75 mm (depending on the type of shower drain), the BFR 75 is ideal for interior renovations.

See technical information for details: Poresta® BFR 75
page 40

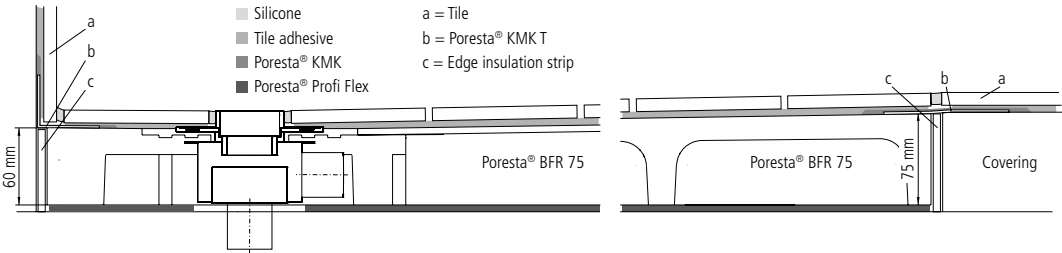

15



Floor-level shower systems

Poresta® Slot

Water simply disappears – shadow gap drain with double-sided gradient



Easy to clean with special brush (included)



reddot design award
winner 2009



The unique, award-winning shadow gap drainage system makes water practically disappear along two wall edges. The double-sided gradient makes the Poresta® Slot ideal for installation in niches and corners. This floor-level shower and drain system is also easy to clean.

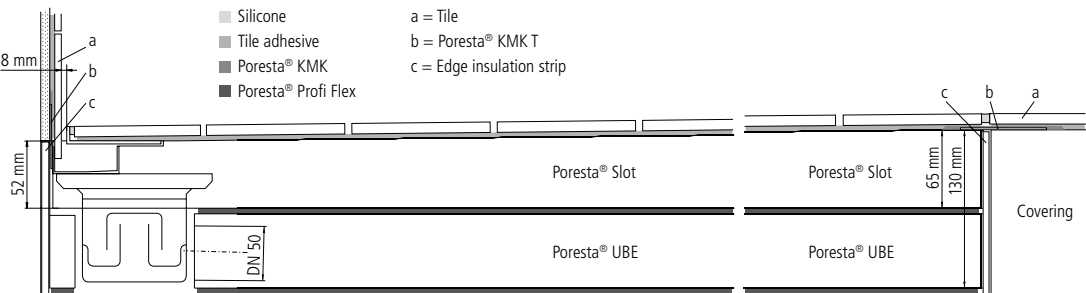

See technical information for details: [Poresta® Slot](#)
page 42

Poresta® Slot S

Water simply disappears – shadow gap drain with single-sided gradient

18



The Poresta Slot S features a shadow gap drain along the wall. This enables large-dimension tiling without gradient sectioning. Shower water disappears safely under the tile surface thanks to an innovative drainage system. A single-sided gradient makes the Poresta® Slot S ideal for installation in niches, corners, or along a single wall. Cleaning this floor-level shower and drain system is quick and easy.

See technical information for details: Poresta® Slot S
page 44

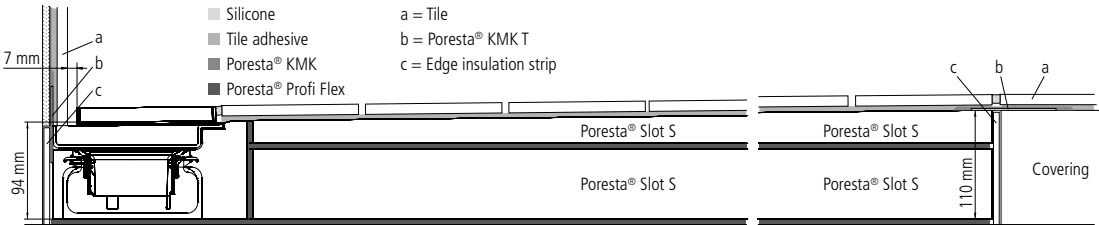

19

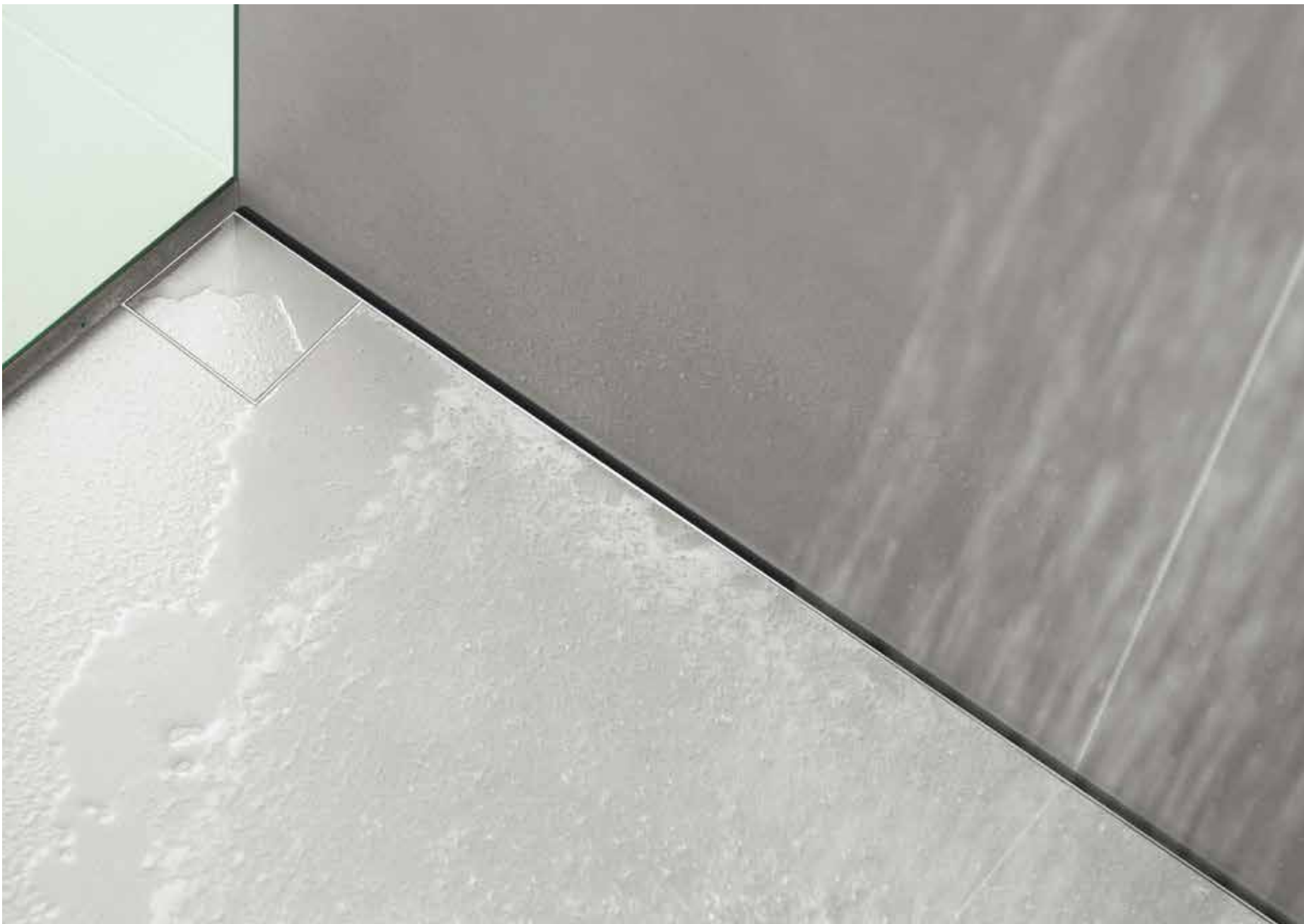

Floor-level shower systems

Poresta® Plus Ge

Shower board for the Geberit wall drain



Photo: Geberit



This Poresta® Plus Ge shower element works perfectly with the Geberit® wall drain. The gradient in front of the drain can be installed quickly and safely – and the surface can be easily tiled to suit individual needs.

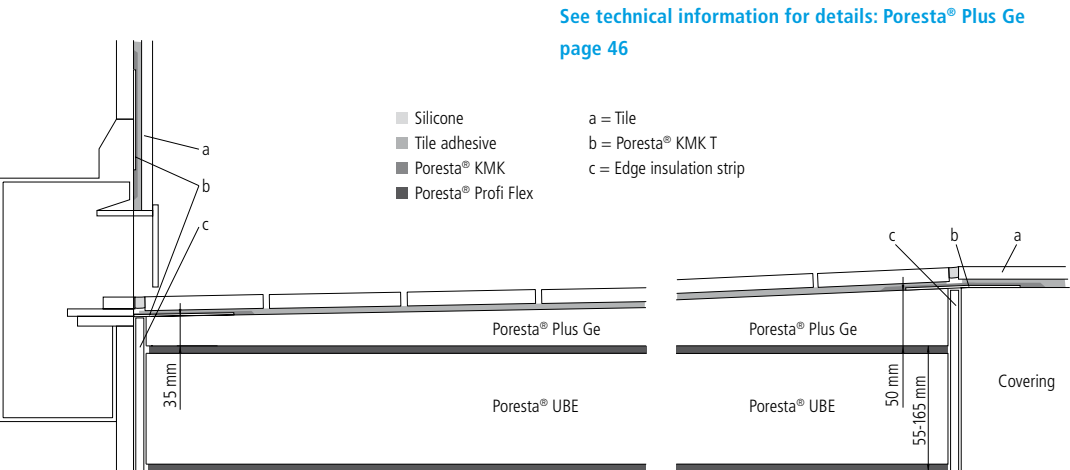

Poresta® Loft

The inspiration of straight lines

22



The surfaces of the new Poresta® Loft convey a flawless impression. The shower area blends harmoniously into the bathroom without a visible edge. The fine mineral composite of Poresta® Loft creates a smooth and silky feeling against your feet. Loft comes in many dimensions and can be fitted ultra-flat. The surface and drain are easy to maintain. The shower comes with a circumferential sealing sleeve.

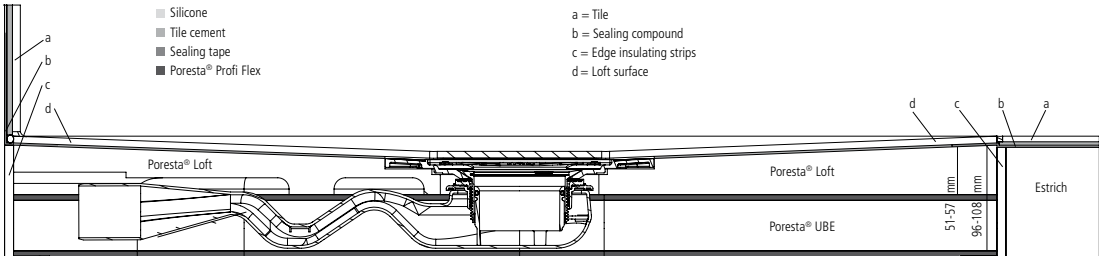

See technical information for details: [Poresta® Loft](#)
page 48

23

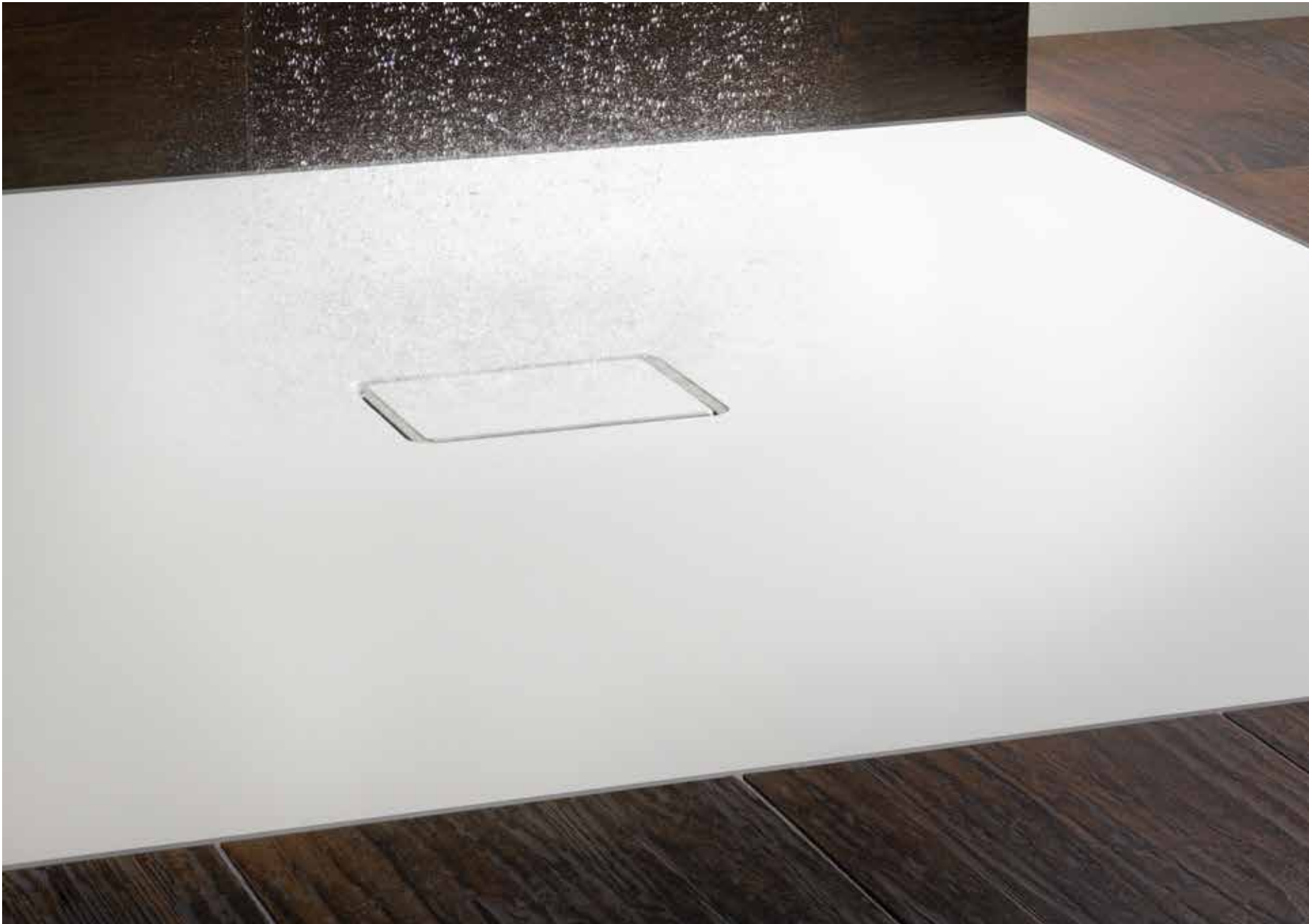

Floor-level shower systems

Poresta® Loft S

The inspiration of straight lines



Flush with the floor on all sides with a gradient on one side – the shower area of the new Poresta® Loft S blends perfectly into your bathroom. The perfect surface shaping guides the shower water into the discreet outlet. Its clean lines skilfully showcase the shower area. Loft S stands out from the crowd on account of its many dimensions, easy-clean outlet and surface and simple installation, thanks to the integral sealing sleeve.

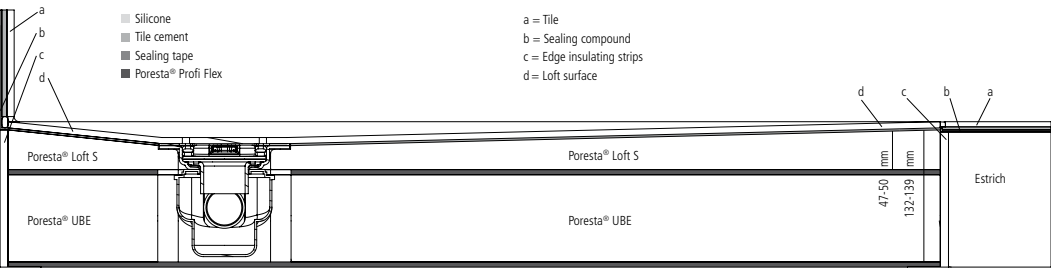

See technical information for details: Poresta® Loft S
page 50

Poresta® floor-level shower systems

Product benefits

26

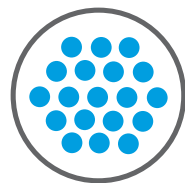

Poresta® material

Poresta® is the base material for Poresta® floor-level shower systems. Poresta® is an expanded polystyrene foam (EPS). Poresta® for floor-level shower systems is produced with a gross density of $>80 \text{ kg/m}^3$, making it extremely stable and resistant to pressure. Poresta® is also extremely lightweight and can be easily cut and shaped.



Waterproof coating

All Poresta® floor-level shower systems are coated at the factory to ensure a waterproof surface. Most of the shower elements are sealed with a high-quality plastic/mortar composite material. Poresta® BF is coated with a dispersion. With the Poresta® Loft/Loft S, the mineral composite surface in conjunction with the factory-integrated sealing sleeve provides the seal.



Integrated gradient

Poresta® floor-level shower systems can be installed without laying a complicated slope in the floor screed. The gradient is fully integrated into the surface of the shower system at the factory. This ensures that shower water flows safely into the drain.



Standardized drain technology

The drain technology used with Poresta® floor-level shower systems is subject to different standards. All drains can be connected to a standard DN 50 pipe. The trap height of 50 mm is in compliance with DIN 274. A unique feature is the horizontal drain with Poresta® BF 70, Poresta® Limit S 95 and Slot S. The trap height for these systems is not equivalent to 50 mm, however usability is verified with a general construction test certificate.

27



Custom tiling

Poresta® floor-level shower systems are tiled after installation (except Poresta® Loft/Loft S, which is pre-finished). The variety of tile colours and shapes are practically unlimited. The choices range from rectangular ceramic or natural stone tiles, to mosaics. The poresta systems technical department will gladly provide further details about the suitability of special floor covering materials.



Wheelchair accessible

Poresta® floor-level shower systems are suitable for use with wheelchairs. This requires floor tiles with minimum dimensions of 100 x 100 mm. When a glass fibre mesh is integrated into the tile adhesive, tiles measuring 50 x 50 mm can be used.



Easy to clean

Ceramic or natural stone surfaces can be cleaned using normal household cleaners. Detachable drain traps make it easy to remove hair, soap residue, etc.



Tested for barrier-free accessibility

Poresta® floor-level shower systems are thoroughly tested for barrier-free accessibility in compliance with DIN Certco. Poresta® floor-level shower systems suitable for barrier-free accessibility are labelled with the DIN Certco seal of approval.

Poresta® floor-level shower systems

Product benefits

28



Certified soundproofing

Poresta® floor-level shower systems can be combined with Poresta® soundproofing accessories. The basic and complete soundproofing sets deliver excellent sound insulation against noise from building technical systems. Results are also available for impact noise reduction. Test certificates have been issued verifying compliance with DIN 4109, ÖNORM B 8115-2 and SIA 181. Complete details are outlined in the current DIN 4109/VDI 4100, ÖNORM B 8115-2 and SIA 181 soundproofing brochures. The poresta systems technical staff will gladly provide details on soundproofing for Poresta® floor-level shower systems.



Secure sealing

Poresta® floor-level shower systems are given a waterproof coating in the factory. The shower systems, which are coated in the factory with a plastic/mortar composite-based mineral sealant, can be used with moderate and also high levels of moisture in accordance with the Central Association of the German Construction Industry data sheet (Alternative sealing in compound structures). This is documented by a general building inspectorate test result (abP) and European Technical Assessment (ETA). They are also suitable for use as a plate-shaped sealing material for water penetration class W2-I in accordance with DIN 18534-6. All Poresta® shower systems can also be used as a base surface in compliance with DIN 18534-1 up to water penetration class W3-I if they are fully coated on site with liquid sealant in compliance with DIN 18534-3.

In Austria, Vienna-based OFI Technologie und Innovation GmbH certifies that Poresta® BF KMK, BF 95, BF 70, Limit S, Limit S 95, Slot, Slot S and Plus Ge products, coated with a plastic/mortar composite, conform to the requirements of the ÖNORM B 3407 standard when properly laid. Accordingly, Poresta® floor-level shower systems can be classified up to the highest group W5 in accordance with the moisture exposure classes defined in the standard.



Fireproofing

Poresta® is a class B2 (DIN 4102 – normal flammability) building material. The Poresta® fireproofing set for Poresta® BF/BF KMK is available for installation with a vertical drain.

29

Easy installation

Poresta® floor-level shower systems can be safely installed in just a few easy steps. Field service staff from poresta systems are available to demonstrate assembly at the construction site.

Poresta® BF KMK installation



Poresta® BF KMK is available with all of the accessories required for installation. (Please note the scope of supply when ordering.)



Trim the floor-level shower system to size.



Mark the position of the drain.



Measure and align the drain.



Cut the Poresta® foundation element to accommodate the drainpipe and use the buttering/floating method to attach the element to the floor surface.



Attach the Poresta® BF KMK to the foundation element using the buttering/floating method.



Use a spirit level to align the shower system.



Remove the insulation strip using a carpet cutter.



Seal the Poresta® BF KMK to the wall using Poresta® BF KMK sealing accessories.



After the second layer of sealing compound has dried, the shower system is ready for tiling.



The grate frame is embedded in the tile adhesive and aligned with the surrounding tile.

This is a summary of the installation instructions for Poresta® BF KMK. For installation on site, all instructions should be carefully followed step by step.

Poresta® BF/BF KMK

Technical information

30

Basics

- Waterproof, coated, ready-to-tile hard foam shower system with integrated gradient of approx. 2.0–2.5%, centred or offset, integrated and sealed drain plate with vertical or horizontal drain
- Poresta® BF/BF KMK horizontal drain: flow rate 33 l/min, standard DN 50 connection
- Poresta® BF/BF KMK vertical drain: flow rate 60 l/min, standard DN 50 connection
- Water trap height 50 mm based on DIN EN 274
- Depending on the geometry and installation height, the shower system can be cut on-site by the installer up to 50 mm on all sides, taking into account the specific usage (splash protection, area of movement, etc.)

dreh- und verschiebbarer Rostrahmen

Sealing

- Poresta® BF: for moderate moisture exposure
- Poresta® BF KMK: for moderate to high moisture exposure
- Poresta® BF KMK: Can be used as a plate-shaped sealing material in compliance with DIN 18534-6 up to water penetration class W2-I; Poresta® BF/BF KMK: as a base surface in compliance with DIN 18534-1; fully coated with liquid sealant in compliance with water penetration class W3-I as per DIN 18534-3
- General construction testing certificate according to List A, Part 2, Section 2.50 (sealing in conjunction with tile and slab floor coverings), testing certificate under www.poresta.com

- ÖNORM B 3407: When professionally installed, Poresta BF KMK complies with load classes specified in the standard up to maximum group W5
- Poresta® BF KMK: Includes CE certificate in compliance with ETAG 022 Part 3

Soundproofing: Poresta® BF KMK

- DIN 4109/VDI 4100/SIA 181/ÖNORM B 8115-2: Technical reports from the Fraunhofer Institute for Building Physics verify the achievable noise levels (water impact noise, EMPA hammer, impact noise reduction) for installations with Poresta® soundproofing accessories. See the soundproofing brochure for details: www.poresta.com

Fireproofing

The Poresta® BF fireproofing set is available for Poresta® BF and Poresta® BF KMK with vertical drain. This can be installed in F 30 to F 120 ceilings in accordance with DIN 4102 (general construction testing certificate DIBT Z-19.17-1543). Details are outlined in the installation instructions/test certificate.

Barrier-free accessibility

- Suitable for barrier-free accessibility
- Sufficient stability for use with wheelchairs can be achieved by using tiles with minimum dimensions of 100 x 100 mm
- Sufficient stability for use with wheelchairs can be achieved by using tiles with minimum dimensions size of 50 x 50 mm when an additional glass fibre mesh is integrated into the tile adhesive

Accessories

- Four different stainless steel drain grate designs
- Poresta® BF ready-to-tile drain cover (must be ordered separately prior to installation)
- Variable extension element for different tile thicknesses
- Poresta® Profi Flex rapid-acting adhesive
- Poresta® UBE Foundation elements for height adjustment in expanded polystyrene as an alternative to screed base
- Poresta® soundproofing sets
- Poresta® Safety Cut 3.6 m
- Poresta® KMK sealing compound, 2 kg containers (Plastic/mortar composite material)
- Poresta® KMK T Sealing strip from transversally elastic, fleece-lined joint sealing strip (120 mm wide) for sealing joints below ceramic surfaces in damp and wet room environments
- Poresta® KMK TI inner corner, diagonally elastic, fleece-lined
- Poresta® KMK TA outer corner, diagonally elastic, fleece-lined
- Poresta® BFA, lösemittelfreie Dispersionsabdichtung für Poresta® BF, gebrauchsfertig, 6 kg Gebinde



Watch installation video

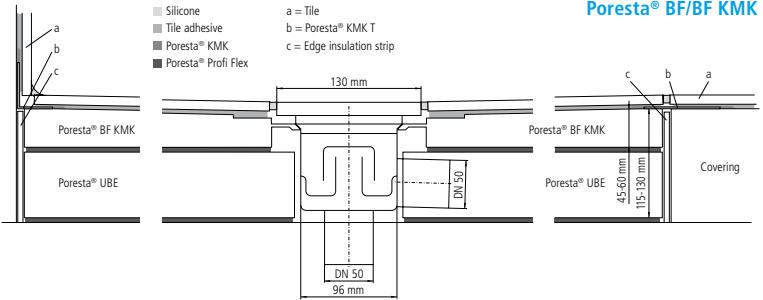

Schematic section drawing:
Poresta® BF/BF KMK

A	B	C1	C2	Element height	Installation height, vertical drain	Installation height, horizontal drain
750	900	375	450	45	45	115
800	800	400	400	45	45	115
900	800	450	400	45	45	115
900	900	450	450	45	45	120
900	900	250	250	45	45	115 dz
1000	800	500	400	45	45	120
1000	900	500	450	50	50	120
1000	1000	500	500	50	50	120
1000	1000	250	250	45	45	120 dz
1000	1200	500	600	50	50	120
1100	800	550	400	50	50	120
1100	900	550	450	50	50	120
1100	1000	550	500	50	50	120
1100	1100	550	550	50	50	120
1200	800	600	400	50	50	120
1200	900	600	450	50	50	120
1200	1200	600	600	50	50	120
1200	1200	250	250	50	50	120 dz
1300	900	650	450	45	45	120
1300	1100	650	550	50	50	120
1400	900	700	450	45	45	125
1500	900	750	450	50	50	125
1500	1300	750	650	50	55	130
1500	1500	250	250	60	60	135 dz
1500	1500	750	750	50	50	125
1800	800	900	400	50	50	125
1800	900	900	450	50	50	125

A	B	C1+ C2	D1+ D2	E	Element height	Installation height, vertical drain	Installation height, horizontal drain
900	900	450	350	R: 550	45	45	115
900	900	250	350	R: 550	45	45	115 dz
1000	1000	500	455	R: 545	50	50	120
1000	1000	250	455	R: 545	45	45	120 dz

A	B	C1+ C2	D1+ D2	E	Element height	Installation height, vertical drain	Installation height, horizontal drain
900	900	450	476	600	45	45	115
900	900	250	476	600	45	45	115 dz
1000	1000	500	491	720	50	50	120
1000	1000	250	491	720	45	45	115 dz

Made-to-measure shower systems in custom sizes and shapes available on request.
Dimensions in mm; dz = offset drain, R = radius

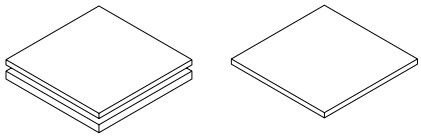

Foundation elements

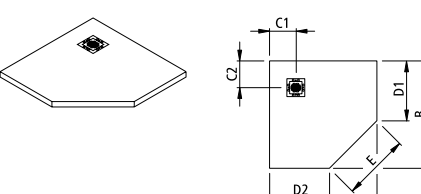
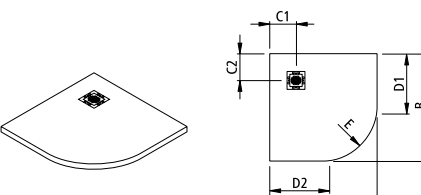
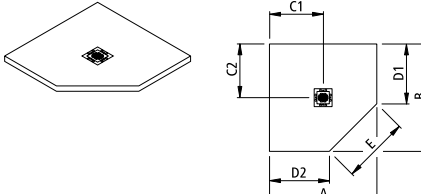
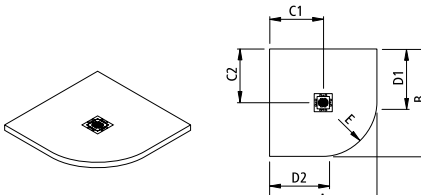
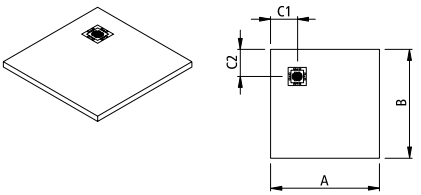
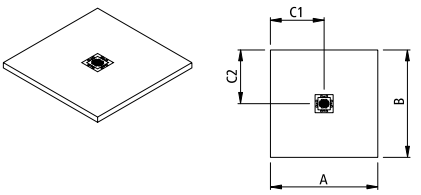

Poresta® BF 95

Technical information

32

Basics

- Waterproof, coated, ready-to-tile hard foam shower system with integrated gradient of approx. 2.0–2.5%, centred or offset, integrated and sealed drain plate with horizontal drain
- Horizontal drain: flow rate 36 l/min, standard DN 50 connection
- Water trap height 50 mm based on DIN EN 274
- Depending on the geometry and installation height, the shower system can be cut on-site by the installer up to 50 mm on all sides, taking into account the specific usage (splash protection, area of movement, etc.)

- Rotatable grate frame

Barrier-free accessibility

- Suitable for barrier-free accessibility
- Sufficient stability for use with wheelchairs can be achieved by using tiles with minimum dimensions of 100 x 100 mm
- Sufficient stability for use with wheelchairs can be achieved by using tiles with minimum dimensions size of 50 x 50 mm when an additional glass fibre mesh is integrated into the tile adhesive

Sealing

- For moderate to high moisture exposure (class A0 and A₁ in accordance with ZDB spec sheet)
- General construction testing certificate according to List A Part 2, Section 2.50 (sealing in conjunction with tile and slab floor coverings)
- ÖNORM B 3407: When professionally installed, complies with load classes specified in the standard up to maximum group W5
- Includes CE certificate in compliance with ETAG 022 Part 3

Soundproofing

- DIN 4109 / SIA 181 / ÖNORM B 8115-2: Technical reports from the Fraunhofer Institute for Building Physics verify the achievable noise levels (water impact noise, EMPA hammer, impact noise reduction) for installations with Poresta® soundproofing accessories. See the soundproofing brochure for details: www.poresta.com

Accessories

- Four different stainless steel drain grate designs
- Variable extension element for different tile thicknesses
- Poresta® Profi Flex rapid-acting adhesive
- Poresta® UBE Foundation elements for height adjustment in expanded polystyrene as an alternative to screed base
- Poresta® soundproofing sets
- Poresta® KMK T Sealing strip from transversally elastic, fleece-lined joint sealing strip (120 mm wide) for sealing joints below ceramic surfaces in damp and wet room environments
- Poresta® KMK TI inner corner, diagonally elastic, fleece-lined
- Poresta® KMK TA outer corner, diagonally elastic, fleece-lined
- Poresta® KMK sealing compound, 2 kg containers (Plastic/mortar composite material)
- Poresta® Safety Cut 3.6 m

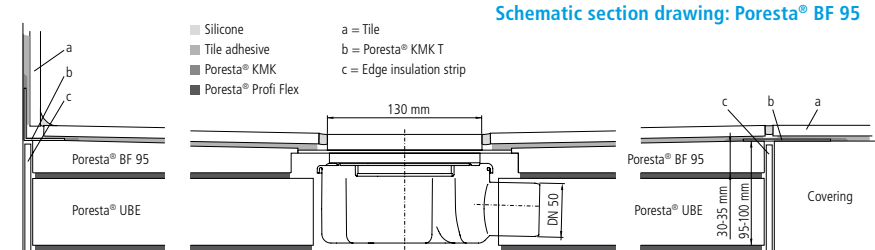

A	B	C1	C2	Element height	Installation height, horizontal drain
750	900	375	450	30	95
800	800	400	400	30	95
900	800	450	400	30	95
900	900	450	450	30	95
900	900	250	250	30	95 dz
1000	800	500	400	30	95
1000	900	500	450	35	95
1000	1000	500	500	35	95
1000	1000	250	250	35	95 dz
1000	1200	500	600	35	97
1100	800	550	400	35	97
1100	900	550	450	35	97
1100	1000	550	500	35	97
1100	1100	550	550	35	97
1200	800	600	400	35	97
1200	900	600	450	35	97
1200	1200	600	600	35	100
1200	1200	250	250	35	100 dz
1300	900	650	450	35	100
1300	1100	650	550	35	100
1400	900	700	450	30	100
1400	1100	700	550	35	100

A	B	C1+ C2	D1+ D2	E	Element height	Installation height, horizontal drain
900	900	450	350	R: 550	30	95
900	900	250	350	R: 550	30	95 dz
1000	1000	500	455	R: 545	35	95
1000	1000	250	455	R: 545	35	95

A	B	C1+ C2	D1+ D2	E	Element height	Installation height, horizontal drain
900	900	450	476	600	30	95
900	900	250	476	600	30	95 dz
1000	1000	500	491	720	35	95
1000	1000	250	491	720	35	95

Dimensions in mm

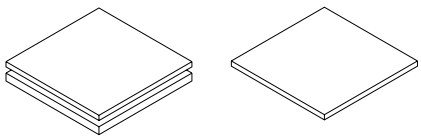

Foundation elements

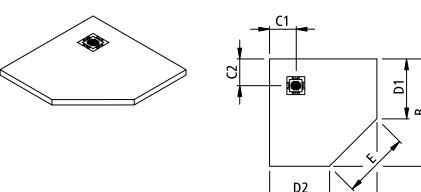
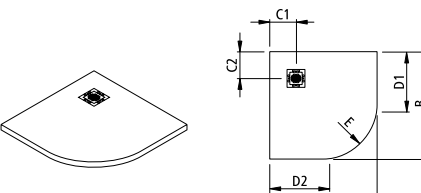
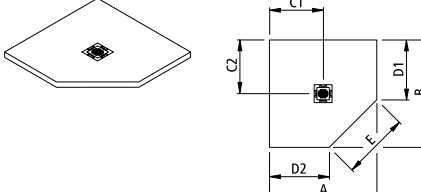
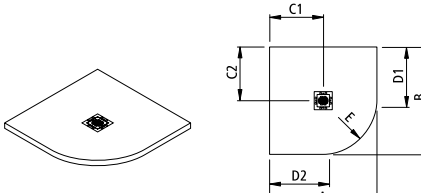
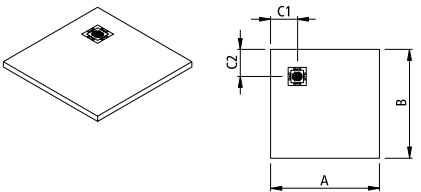
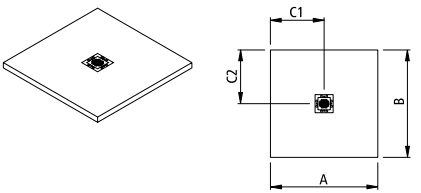

33

Poresta® BF 70

Technical information

34

Basics

- Waterproof, coated, ready-to-tile hard foam shower system with integrated gradient of approx. 2.0% with centre-mounted integrated and sealed horizontal drain
- Standard element 1000 x 1000 x 68 mm, 1200 x 1200 x 70 mm and 1800 x 900 x 71 mm
- Flow rate 35 l/min, standard DN 50 connection
- Dry-out protection with second water trap chamber
- Easy cleaning with Ø 6 mm plumber's snake
- Drain with general construction testing certificate
- Unter Berücksichtigung von Geometrie und Einbauhöhe und des Ablaufsystems kann das Duschsystem Poresta BF 70 1000 x 1000 mm, 1200 x 1200 mm seitens des Verarbeiters umlaufend auf bis zu 900 x 700 mm gekürzt werden, das Duschsystem Poresta BF 70 1800 x 900 mm auf seitens des Verarbeiters auf bis 1500 x 700 mm gekürzt werden - dabei ist die jeweilige Art und Weise der Nutzung des Duschplatzes (Spritzschutz, Bewegungsfläche etc.) zu berücksichtigen
- Can be extended to 1500 x 1500 x 70 mm with add-on elements

Sealing

- For moderate to high moisture exposure (class A0 and A, in accordance with ZDB spec sheet)
- General construction testing certificate according to List A Part 2, Section 2.50 (sealing in conjunction with tile and slab floor coverings)
- ÖNORM B 3407: When professionally installed, complies with load classes specified in the standard up to maximum group W5
- Includes CE certificate in compliance with ETAG 022 Part 3

Soundproofing

- DIN 4109 / SIA 181 / ÖNORM B 8115-2: Technical reports from the Fraunhofer Institute for Building Physics verify the achievable noise levels (water impact noise, EMPA hammer, impact noise reduction) for installations with Poresta® soundproofing accessories. See the soundproofing brochure for details: www.poresta.com

Barrier-free accessibility

- Suitable for barrier-free accessibility
- Sufficient stability for use with wheelchairs can be achieved by using tiles with minimum dimensions of 100 x 100 mm
- Sufficient stability for use with wheelchairs can be achieved by using tiles with minimum dimensions size of 50 x 50 mm when an additional glass fibre mesh is integrated into the tile adhesive

Accessories

- Coated add-on element, 1350 x 150 x 70 mm (can be cut)
- Four different stainless steel drain grate designs
- Variable extension element for different tile thicknesses
- Poresta® Profi Flex rapid-acting adhesive
- Poresta® UBE Foundation elements for height adjustment in expanded polystyrene as an alternative to screed base
- Poresta® soundproofing sets
- Poresta® KMK T Sealing strip from transversally elastic, fleece-lined joint sealing strip (120 mm wide) for sealing joints below ceramic surfaces in damp and wet room environments
- Poresta® KMK TI inner corner, diagonally elastic, fleece-lined
- Poresta® KMK TA outer corner, diagonally elastic, fleece-lined
- Poresta® KMK sealing compound, 2 kg containers (Plastic/mortar composite material)
- Poresta® Safety Cut 3.6 m



Schematic section drawing: Poresta® BF 70

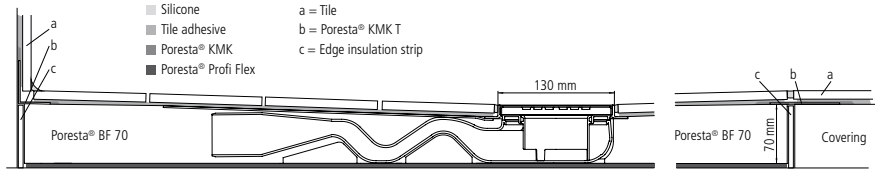

A	B	C1	C2	Element height	Installation height, horizontal drain
1000	1000	500	500	68	68
1200	1200	600	600	70	70
1800	900	450	500	71	71
1350	150			70	69 Extension piece

Dimensions in mm

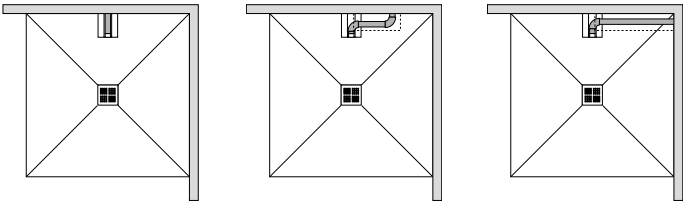

Installation situations

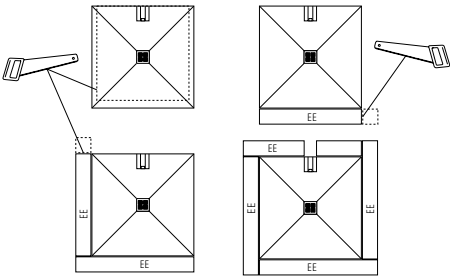
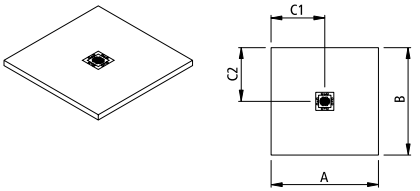

Cutting options/use of add-on elements

35

Poresta® Limit S

Technical information

36

Basics

- Waterproof, coated, ready-to-tile hard foam shower system with integrated gradient of approx. 2.0–2.5%, offset, sealed drain plate with vertical or horizontal drain, 180 degree rotatable grate frame with integrated seal
- Single-sided gradient
- Drain can be positioned along the wall
- Drain channel width: 80 mm
- Rinnenlängen in 770; 870 und 1070 mm verfügbar
- Offset drain position in the grate frame makes the distance from the wall variable (see C1 and C2 in the table) so that standard tiles and natural stone can be used for wall covering
- Grate frame can be simply set in the tile adhesive
- Drainage flow rate can be optionally increased with second drain (factory installed)
- Drainage flow rate: 30 l/min, standard DN 50 connection
- Depending on the geometry and installation height, the shower system can be cut on-site by the installer up to 50 mm on all sides, taking into account the specific usage (splash protection, area of movement, etc.)
- High-quality removable grate cover in brushed stainless steel, frame height: 12 mm, available in three different designs (C, D, E)
- Weitere Größen auf Anfrage

Sealing

- For moderate to high moisture exposure (class A0 and A, in accordance with ZDB spec sheet)
- General construction testing certificate according to List A Part 2, Section 2.50 (sealing in conjunction with tile and slab floor coverings)
- ÖNORM B 3407: When professionally installed, complies with load classes specified in the standard up to maximum group W5
- Includes CE certificate in compliance with ETAG 022 Part 3

Soundproofing

- DIN 4109 / SIA 181 / ÖNORM B 8115-2: Technical reports from the Fraunhofer Institute for Building Physics verify the achievable noise levels (water impact noise, EMPA hammer, impact noise reduction) for installations with Poresta® soundproofing accessories. See the soundproofing brochure for details: www.poresta.com

Barrier-free accessibility

- Suitable for barrier-free accessibility
- Sufficient stability for use with wheelchairs can be achieved by using tiles with minimum dimensions of 100 x 100 mm
- Sufficient stability for use with wheelchairs can be achieved by using tiles with minimum dimensions size of 50 x 50 mm when an additional glass fibre mesh is integrated into the tile adhesive

Accessories

- Poresta® Profi Flex rapid-acting adhesive
- Poresta® UBE Foundation elements for height adjustment in expanded polystyrene as an alternative to screed base
- Poresta® soundproofing sets
- Poresta® KMK T Sealing strip from transversally elastic, fleece-lined joint sealing strip (120 mm wide) for sealing joints below ceramic surfaces in damp and wet room environments
- Poresta® KMK TI inner corner, diagonally elastic, fleece-lined
- Poresta® KMK TA outer corner, diagonally elastic, fleece-lined
- Poresta® KMK sealing compound, 2 kg containers (Plastic/mortar composite material)
- Poresta® Safety Cut 3.6 m

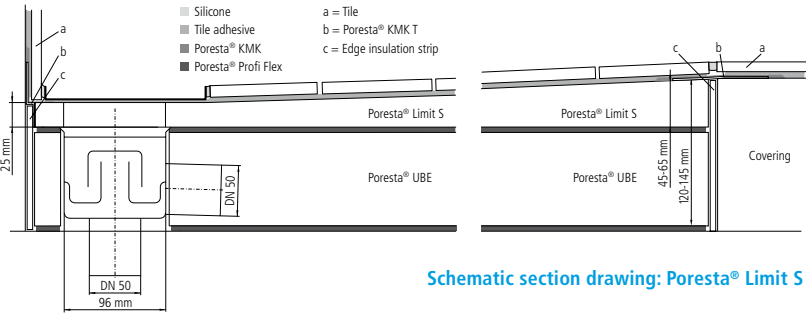

Schematic section drawing: Poresta® Limit S

A	B	*C1	*C2	D	E	Grate dimensions	Element height	Installation height, vertical drain	Installation height, horizontal drain
900	900	47	73	450	65	670 x 80 x 12	45	45	120
900	1000	47	73	450	65	670 x 80 x 12	45	45	120
900	1200	47	73	450	65	670 x 80 x 12	50	50	130
900	1500	47	73	450	65	670 x 80 x 12	55	55	135
900	1800	47	73	450	65	670 x 80 x 12	60	60	140
900	900	47	73	450	65	770 x 80 x 12	45	45	120
900	1000	47	73	450	65	770 x 80 x 12	45	45	120
900	1200	47	73	450	65	770 x 80 x 12	50	50	130
900	1500	47	73	450	65	770 x 80 x 12	55	55	135
900	1800	47	73	450	65	770 x 80 x 12	60	60	140
900	2000	47	73	450	65	770 x 80 x 12	65	65	145
1000	1000	47	73	500	65	870 x 80 x 12	45	45	125
1000	1200	47	73	500	65	870 x 80 x 12	50	50	125
1000	1500	47	73	500	65	870 x 80 x 12	55	55	135
1000	1800	47	73	500	65	870 x 80 x 12	60	60	140
1000	2000	47	73	500	65	870 x 80 x 12	65	65	145
1200	1200	47	73	600	65	1070 x 80 x 12	50	50	130
1200	1500	47	73	600	65	1070 x 80 x 12	55	55	135
1200	1800	47	73	600	65	1070 x 80 x 12	60	60	140
1200	2000	47	73	600	65	1070 x 80 x 12	65	65	145

* C1: Measurement to grate centre for use with standard tiles
* C2: Measurement to grate centre for use with natural stone tiles

Stainless steel grates must be ordered separately!
Dimensions in mm

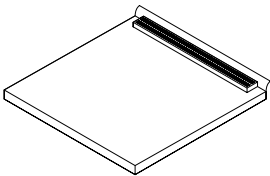
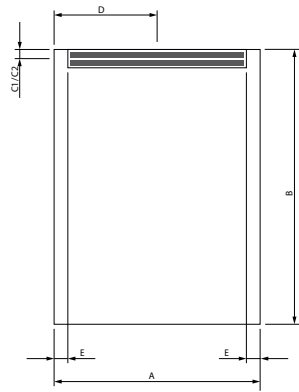

Grate fitting can be rotated by 180° depending on flooring material:

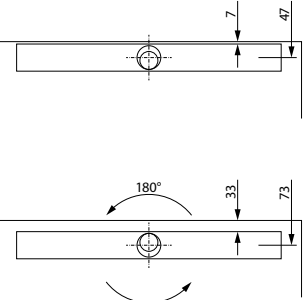

C1 = 47 mm (e.g. standard tiles)

C2 = 73 mm (e.g. natural stone)

37

Poresta® Limit S 95

Technical information

38

Basics

- Two-part, waterproof-coated, tilable hard-foam shower system, with integrated gradient of approx. 1.5 %, offset sealed drain plate with horizontal drain allowing connection from either side, 180-degree rotatable grate frame as well as an integrated sealing strip for the grate side
- Two Single-sided gradient – no gradient sectioning needed
- Installed height just 95 mm with a shower area of 1000 x 1000 mm
- One standard component 1200 x 1200 x 98 mm
- Drainage flow rate 54 l/min. with a horizontal drain and a standard DN 50 connection
- Removable hair trap
- Easy-to-clean siphon
- Drain channel can be positioned next to the wall
- Drain channel width 80 mm
- Drain channel available in 770, 870 and 1070 mm lengths
- Offset drain position in the grate fitting frame makes the distance from the wall variable, thus allowing the use of standard tiles and natural stone on the walls
- Grate frame can simply be set into the bed of tile adhesive
- Depending on the geometry and installation height, the installer can cut the shower system on the short and long sides – however, the way in which the shower area is to be used (splash protection, space to move etc.) must be taken into account at the same time

- High-quality removable gratings in matt brushed stainless steel, grate frame height: 12 mm in three different designs (C, D, E) as well as a tilable, removable stainless-steel grate insert (Design F)

Sealing

- For moderate to high moisture exposure (class A0 and A, in accordance with ZDB spec sheet)
- General construction testing certificate according to List A Part 2, Section 2.50 (sealing in conjunction with tile and slab floor coverings)
- ÖNORM B 3407: When professionally installed, complies with load classes specified in the standard up to maximum group W5
- Includes CE certificate in compliance with ETAG 022 Part 3

Soundproofing

- DIN 4109 / SIA 181 / ÖNORM B 8115-2: Test certificates and technical reports from the Fraunhofer Institute for Building Physics confirming the achievable noise levels (water impact noise, EMPA hammer, footstep noise reduction) for installations with Poresta® soundproofing accessories are available. See the soundproofing brochure at www.poresta.com

Barrier-free accessibility

- Barrier-free installation possible
- Sufficient stability for use with wheelchairs can be achieved by using tiles with minimum dimensions of 100 x 100 mm

- When using tiles with minimum dimensions of 50 x 50 mm, sufficient stability for use with wheelchairs can be achieved by integrating an additional glass fibre mesh into the tile adhesive

Accessories

- Add-on element, 1200 x 600 x 98/105 mm can be cut
- Poresta® Profi Flex rapid-acting adhesive
- Poresta® UBE Foundation elements for height adjustment in expanded polystyrene as an alternative to screed base
- Poresta® soundproofing sets
- Poresta® KMK T Sealing strip from transversally elastic, fleece-lined joint sealing strip (120 mm wide) for sealing joints below ceramic surfaces in damp and wet room environments
- Poresta® KMK TI inner corner, diagonally elastic, fleece-lined
- Poresta® KMK TA outer corner, diagonally elastic, fleece-lined
- Poresta® KMK sealing compound, 2 kg containers (Plastic/mortar composite material)
- Poresta® Safety Cut 3.6 m



Schematic section drawing: Poresta® Limit S 95

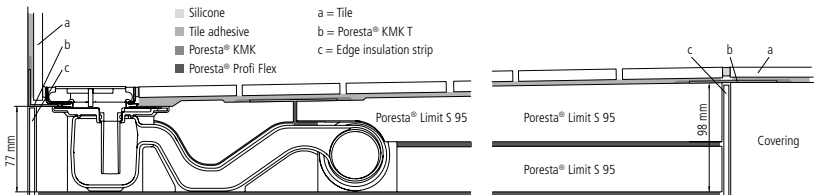
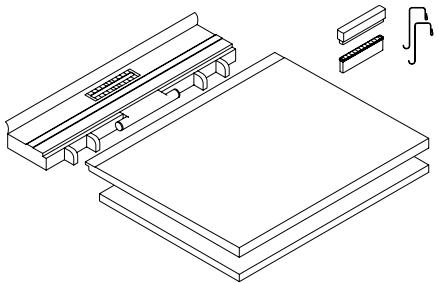

Image	Description	Dimensions mm	For drain channel system
	Poresta® Limit S 95 Single-sided gradient, horizontal drain on the narrow side, without grate frame and grating	1200 x 1200 x 98	770 x 80* 870 x 80* 1070 x 80*
	Poresta® Limit S 95 Extension piece	1200 x 600 x 98/105	

Dimensions in mm
* Length / width

Product parts



View from below

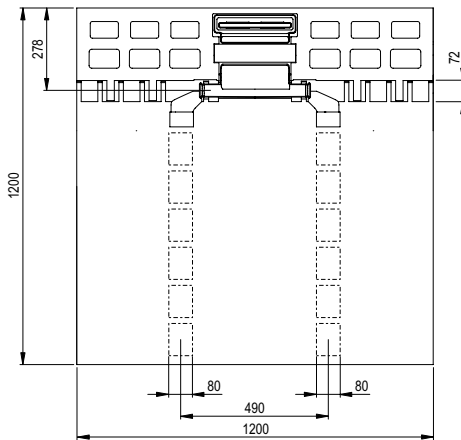

39

Poresta® BFR 75

Technical information

40

Basics

- Waterproof, coated, ready-to-tile hard foam shower system with integrated gradient of 1.5%, fits standard showers with floor channels measuring 600 mm to 1100 mm, including products from the following manufacturers:
 - ACO
 - Dallmer
 - Easy Drain
 - Geberit
 - Sanit
 - TECE
 - Viega
- Standard element 1200 x 1200 x 75 mm
- Single-sided gradient
- Flow rate depends on selected drain channel
- All channel manufacturer's accessories can be used
- Depending on the geometry, installation height and drain channel system, can be cut on-site by the installer, taking into account the specific usage (splash protection, area of movement, etc.)

Barrier-free accessibility

- Suitable for barrier-free accessibility
- Sufficient stability for use with wheelchairs can be achieved by using tiles with minimum dimensions of 100 x 100 mm
- Sufficient stability for use with wheelchairs can be achieved by using tiles with minimum dimensions size of 50 x 50 mm when an additional glass fibre mesh is integrated into the tile adhesive

Sealing

- For moderate to high moisture exposure (class A0 and A, in accordance with ZDB spec sheet)
- General construction testing certificate according to List A Part 2, Section 2.50 (sealing in conjunction with tile and slab floor coverings)
- ÖNORM B 3407: When professionally installed, complies with load classes specified in the standard up to maximum group W5
- Includes CE certificate in compliance with ETAG 022 Part 3

Soundproofing

- DIN 4109 / SIA 181 / ÖNORM B 8115-2: Technical reports from the Fraunhofer Institute for Building Physics verify the achievable noise levels (water impact noise, EMPA hammer, impact noise reduction) for installations with Poresta® soundproofing accessories. See the soundproofing brochure for details: www.poresta.com

Accessories

- Add-on element, 1200 x 600 x 82 mm available for extending the shower section
- Poresta® Profi Flex rapid-acting adhesive
- Poresta® UBE Foundation elements for height adjustment in expanded polystyrene as an alternative to screed base
- Poresta® soundproofing sets
- Poresta® KMK T Sealing strip from transversally elastic, fleece-lined joint sealing strip (120 mm wide) for sealing joints below ceramic surfaces in damp and wet room environments
- Poresta® KMK TI inner corner, diagonally elastic, fleece-lined
- Poresta® KMK TA outer corner, diagonally elastic, fleece-lined
- Poresta® KMK sealing compound, 2 kg containers (Plastic/mortar composite material)
- Poresta® Safety Cut 3.6 m

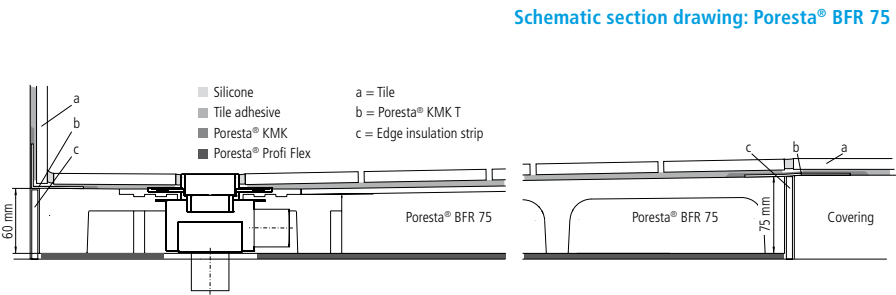

Schematic section drawing: Poresta® BFR 75

Illustration	Description	Dimensions	Installation height
	Poresta® BFR 75	1200 x 1200 x 75	min. 75*
	Extension element	1200 x 600 x 75/82	

Dimensions in mm
* depending on shower drain channel

View of the underside

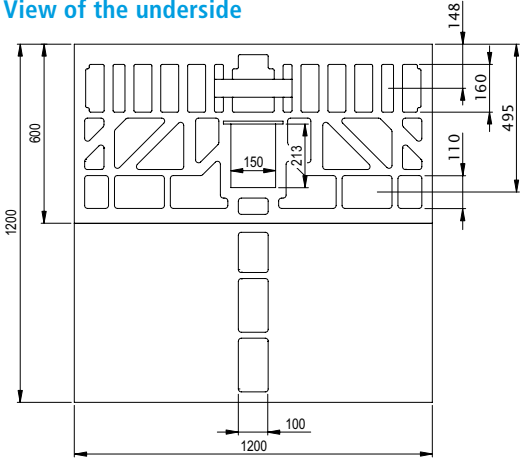

Poresta® BFR 75 shower system components

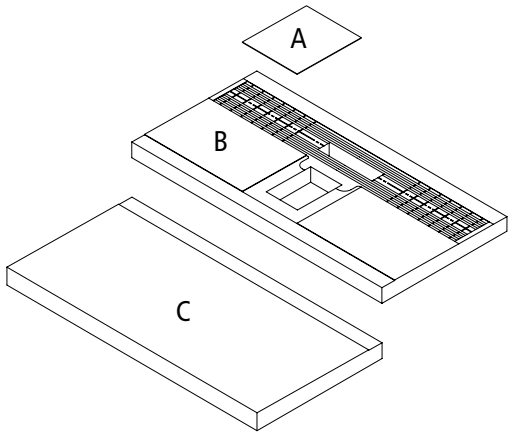

- A cover
- B Shower element for installation of different drain channel types
- C Gradient element

41

Poresta® Slot

Technical information

42

Basics

- Waterproof, coated, ready-to-tile hard foam shower system with integrated gradient of approx. 1.0%, pre-installed drainage channels and drain unit
- Drainage via double-sided shadow gap (double-sided gradient)
- Standard element 1200 x 1200 x 65 mm
- Flow rate horizontal/vertical 36 l/min, standard DN 50 connection
- Depending on the geometry and installation height, the shower system can be cut on-site by the installer to 500 x 500 mm, taking into account the specific usage (splash protection, area of movement, etc.)
- Can be extended with add-on elements
- Minimum tile dimensions: 50 x 50 mm
- Shadow gap is easy to clean with supplied brush

Sealing

- For moderate to high moisture exposure (class A0 and A, in accordance with ZDB spec sheet)
- General construction testing certificate according to List A Part 2, Section 2.50 (sealing in conjunction with tile and slab floor coverings)
- ÖNORM B 3407: When professionally installed, complies with load classes specified in the standard up to maximum group W5

Includes CE certificate in compliance with ETAG 022 Part 3

Soundproofing

- DIN 4109 / SIA 181 / ÖNORM B 8115-2: Technical reports from the Fraunhofer Institute for Building Physics verify the achievable noise levels (water impact noise, EMPA hammer, impact noise reduction) for installations with Poresta® soundproofing accessories. See the soundproofing brochure for details: www.poresta.com

Barrier-free accessibility

- Suitable for barrier-free accessibility
- Sufficient stability for use with wheelchairs can be achieved by using tiles with minimum dimensions of 100 x 100 mm
- Sufficient stability for use with wheelchairs can be achieved by using tiles with minimum dimensions size of 50 x 50 mm when an additional glass fibre mesh is integrated into the tile adhesive

Accessories

- Coated add-on element, 1200 x 600 mm, without channel (can be cut)
- Poresta® Profi Flex rapid-acting adhesive
- Poresta® UBE Foundation elements for height adjustment in expanded polystyrene as an alternative to screed base
- Poresta® soundproofing sets
- Poresta® KMK T Sealing strip from transversally elastic, fleece-lined joint sealing strip (120 mm wide) for sealing joints below ceramic surfaces in damp and wet room environments
- Poresta® KMK TI inner corner, diagonally elastic, fleece-lined
- Poresta® KMK TA outer corner, diagonally elastic, fleece-lined
- Poresta® KMK sealing compound, 2 kg containers (Plastic/mortar composite material)
- Poresta® Safety Cut 3.6 m

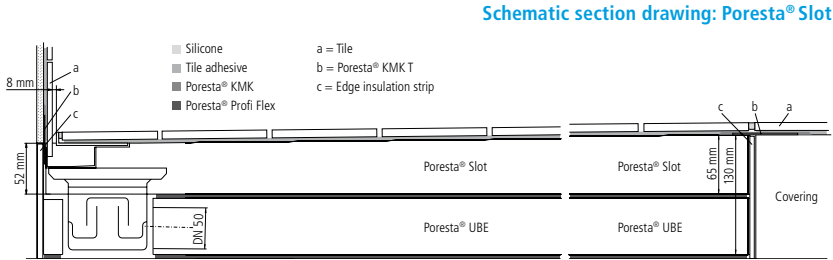

	A	B	Element height	Installation height, vertical drain	Installation height, horizontal drain
Poresta® Slot	1200	1200	65	65	130
Poresta® Slot add-on element	1200	600	65/72	65	130

Dimension in mm
Two different tile profile heights available

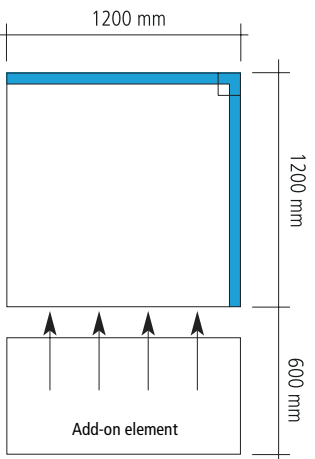

Virtually all sizes and shapes are possible with one standard board



Cleaning brush for Poresta® Slot shower system



Easy to clean

Schematic section drawing: Poresta® Slot

43

Poresta® Slot S

Technical information

44

Basisdaten

- Waterproof, coated, ready-to-tile hard foam shower system with integrated gradient of approx. 1.5%, pre-installed drainage channel
- Drainage via single-sided shadow gap (single-sided gradient)
- Standard element 1200 x 1200 mm
- Flow rate horizontal/vertical 42 l/min, standard DN 50 connection
- Dry-out protection with second water trap chamber for horizontal drain
- Horizontal drain with general construction testing certificate
- Depending on the geometry and installation height, the shower system can be cut on-site by the installer to 700 x 500 mm, taking into account the specific usage (splash protection, area of movement, etc.)
- Can be extended with add-on element
- Minimum tile dimensions: 50 x 50 mm
- Shadow gap is easy to clean with special brush (supplied)

Sealing

- For moderate to high moisture exposure (class A0 and A₁ in accordance with ZDB spec sheet)
- General construction testing certificate according to List A Part 2, Section 2.50 (sealing in conjunction with tile and slab floor coverings)
- ÖNORM B 3407: When professionally installed, complies with load classes specified in the standard up to maximum group W5
- Includes CE certificate in compliance with ETAG 022 Part 3

Soundproofing

- DIN 4109 / SIA 181 / ÖNORM B 8115-2: Technical reports from the Fraunhofer Institute for Building Physics verify the achievable noise levels (water impact noise, EMPA hammer, impact noise reduction) for installations with Poresta® soundproofing accessories. See the soundproofing brochure for details: www.poresta.com

Barrier-free accessibility

- Suitable for barrier-free accessibility
- Sufficient stability for use with wheelchairs can be achieved by using tiles with minimum dimensions of 100 x 100 mm
- Sufficient stability for use with wheelchairs can be achieved by using tiles with minimum dimensions size of 50 x 50 mm when an additional glass fibre mesh is integrated into the tile adhesive

Accessories

- Coated add-on element, 1200 x 600 mm, without channel (can be cut)
- Poresta® Profi Flex rapid-acting adhesive
- Poresta® UBE Foundation elements for height adjustment in expanded polystyrene as an alternative to screed base
- Poresta® soundproofing sets
- Poresta® KMK T Sealing strip from transversally elastic, fleece-lined joint sealing strip (120 mm wide) for sealing joints below ceramic surfaces in damp and wet room environments
- Poresta® KMK TI inner corner, diagonally elastic, fleece-lined
- Poresta® KMK TA outer corner, diagonally elastic, fleece-lined
- Poresta® KMK sealing compound, 2 kg containers (Plastic/mortar composite material)
- Poresta® Safety Cut 3.6 m



Schematic section drawing: Poresta® Slot S

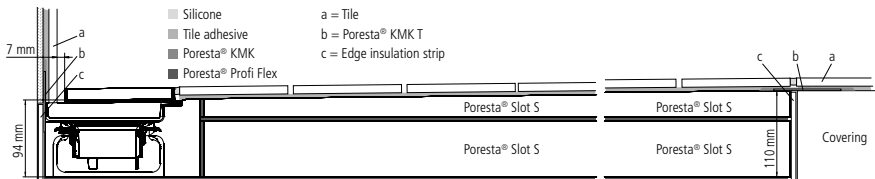

Poresta® Slot S shower system

	Tiles	Version	Dimensions	Drain position*
Shower system Poresta® Slot S	12	horizontal	1200 x 1200 x 110	right
Shower system Poresta® Slot S	22	horizontal	1200 x 1200 x 110	right
Shower system Poresta® Slot S	12	horizontal	2000 x 1200 x 110	right
Shower system Poresta® Slot S	22	horizontal	2000 x 1200 x 110	right
Shower system Poresta® Slot S	12	vertical	1200 x 1200 x 65	right
Shower system Poresta® Slot S	22	vertical	1200 x 1200 x 65	right
Shower system Poresta® Slot S	12	vertical	2000 x 1200 x 65	right
Shower system Poresta® Slot S	22	vertical	2000 x 1200 x 65	right
Shower system Poresta® Slot S	12	horizontal	1200 x 1200 x 110	left
Shower system Poresta® Slot S	22	horizontal	1200 x 1200 x 110	left
Shower system Poresta® Slot S	12	horizontal	2000 x 1200 x 110	left
Shower system Poresta® Slot S	22	horizontal	2000 x 1200 x 110	left
Shower system Poresta® Slot S	12	vertical	1200 x 1200 x 65	left
Shower system Poresta® Slot S	22	vertical	1200 x 1200 x 65	left
Shower system Poresta® Slot S	12	vertical	2000 x 1200 x 65	left
Shower system Poresta® Slot S	22	vertical	2000 x 1200 x 65	left
Extension element for horizontal drain			1200 x 600 x 110/117	
Extension element for horizontal drain			1200 x 600 x 65/72	

Drains must be ordered separately

Horizontal drain (C1)
Vertical drain (C2)

Dimensions in mm

Note: Poresta® soundproofing sets can only be used in the following combinations:

- Poresta® Slot S horizontal shower system with horizontal drain
- Poresta® Slot S horizontal shower system with vertical drain

System components

- A Gradient board
- B Drain slot support element
- C Horizontal or vertical drain system
- D Drain slot end piece
- E Tile profile

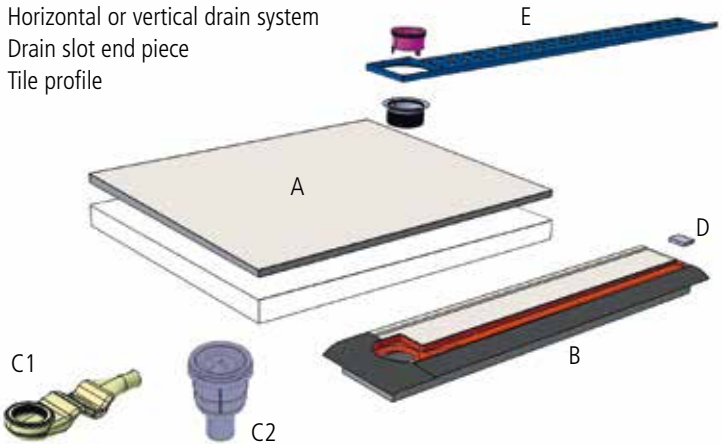

* Definition 1200 x 1200 mm

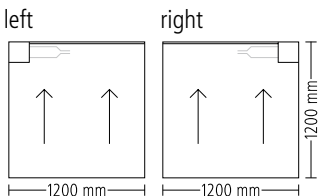

2000 x 1200 mm

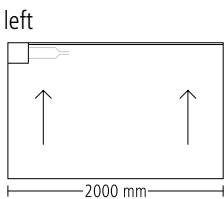

right

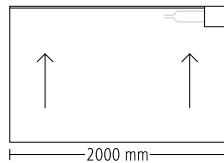

Combinations using multiple Poresta® Slot S systems for large shower spaces with increased flow rate:

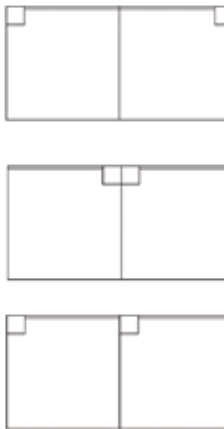

45

Poresta® Plus Ge

Technical information

46

Basics

- Waterproof, coated, ready-to-tile hard foam shower system with integrated gradient of approx. 1.0%
- For use in combination with Geberit® wall drain for easy preparation of a waterproof gradient surface
- Depending on the geometry and installation height, the Poresta® Plus Ge gradient element can be cut on-site by the installer up to 100 mm (no on drain side), taking into account the specific usage (splash protection, area of movement, etc.)

Sealing

- For moderate to high moisture exposure (class A0 and A₁ in accordance with ZDB spec sheet)
- General construction testing certificate according to List A Part 2, Section 2.50 (sealing in conjunction with tile and slab floor coverings)
- ÖNORM B 3407: When professionally installed, complies with load classes specified in the standard up to maximum group W5

Includes CE certificate in compliance with ETAG 022 Part 3

Soundproofing

- DIN 4109 / SIA 181 / ÖNORM B 8115-2: Technical reports from the Fraunhofer Institute for Building Physics verify the achievable noise levels (water impact noise, EMPA hammer, impact noise reduction) for installations with Poresta® soundproofing accessories. See the soundproofing brochure for details: www.poresta.com

Barrier-free accessibility

- Sufficient stability for use with wheelchairs can be achieved by using tiles with minimum dimensions of 100 x 100 mm
- Sufficient stability for use with wheelchairs can be achieved by using tiles with minimum dimensions size of 50 x 50 mm when an additional glass fibre mesh is integrated into the tile adhesive

Accessories

- Poresta® Profi Flex rapid-acting adhesive
- Poresta® UBE Foundation elements for height adjustment in expanded polystyrene as an alternative to screed base
- Poresta® KMK T Sealing strip from transversally elastic, fleece-lined joint sealing strip (120 mm wide) for sealing joints below ceramic surfaces in damp and wet room environments
- Poresta® KMK TI inner corner, diagonally elastic, fleece-lined
- Poresta® KMK TA outer corner, diagonally elastic, fleece-lined
- Poresta® KMK sealing compound, 2 kg containers (Plastic/mortar composite material)
- Poresta® Safety Cut 3.6 m

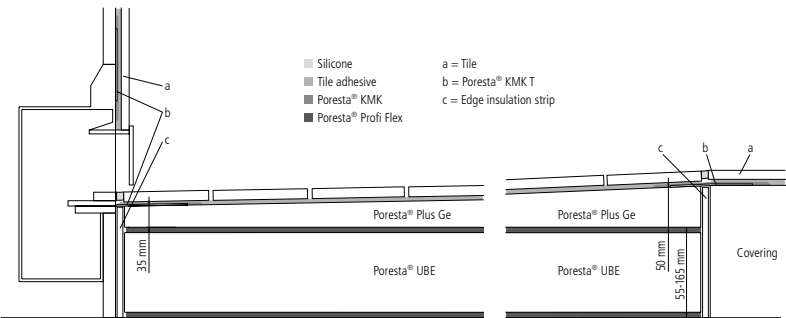

Schematic section drawing: Poresta® Plus Ge

Illustration	Description	Dimensions in mm
	Poresta® Plus Ge square Suitable for Geberit shower element with wall drain: (left or right drain connection) 111.580.00.1, 111.581.00.1, 111.584.00.1, 111.585.00.1, 111.587.00.1, 111.588.00.1, 111.589.00.1, 111.591.00.1, 111.592.00.1, 111.593.00.1, 461.734.00.1, 461.735.00.1, 461.736.00.1, 440.734.00.1, 440.735.00.1, 440.736.00.1, 457.534.00.1, 457.535.00.1, 457.536.00.1	900 x 900 x 50 1000 x 1000 x 52 1200 x 1200 x 57 1400 x 1200 x 57*

For custom orders, please send a scaled drawing with dimensions. Prices on request.
* The installation depends on which Geberit shower elements are used (65-200 mm).

A	B	E	D1	D2
900	900	340	280	280
1000	1000	340	330	330
1200	1200	340	430	430
1400	1200	340	430	430

Dimensions in mm

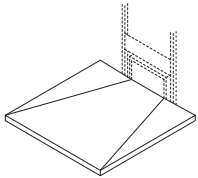
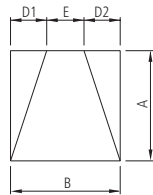

47

Poresta® Loft

Technical data

48

Basic data

- Floor-level shower system, factory prefabricated with white solid mineral composite surface, rectangular mineral composite outlet cover, centred built-in drain unit and factory integrated sealing sleeve with pre-formed corners for sealing to adjoining walls/floors, with pre-formed gradients of 2.0 – 2.5%
- Low net weight
- Complete system with high-quality mineral composite surfaces, horizontal or vertical outlet and circumferential sealing sleeve
- Horizontal super-flat outlet supplied; vertical outlet optional
- Drainage capacity of horizontal super-flat outlet: 36 l/min.
- Drainage capacity of vertical outlet: 42 l/min.
- Connection in accordance with DN 50
- High stability and tread resistance due to the Poresta® support plate
- Certificated R9 slip prevention nach DIN 51130



Seal

- Shower element with factory-integrated sealing seal can be sealed at the wall and floor using Poresta® KMK sealing compound.
- gemäß der DIN 18534-1 als Einbauteil, mit flüssigem Abdichtungsstoff gemäß der DIN 18534-3 eingedichtet bis zur Wassereinwirkungsklasse W3-I
- ÖNORM B 3407: When professionally installed, complies with load classes specified in the standard up to maximum group W5



Soundproofing

- DIN 4109 / ÖNORM B 8115 / SIA 181: There are test certificates or statements from the Fraunhofer Institute for building physics on the sound levels to be achieved (water impact noise, EMPA-hammer and footfall sound insulation) when installing with Poresta® sound insulation accessories.

Barrier-free accessibility

- Accessible for wheelchairs

Accessories

- Poresta® Profi Flex
- Poresta® UBE foundation elements for height adjustment in expanded polystyrene as an alternative to a screed base
- Poresta® KMK TA outer corner, diagonally elastic, fleece-lined
- Poresta® KMK sealing compound, 2 kg containers (Plastic/mortar composite material)
- Poresta® Safety Cut 3.6 m
- Poresta® soundproofing kits



Schematic section drawing: Poresta® Loft

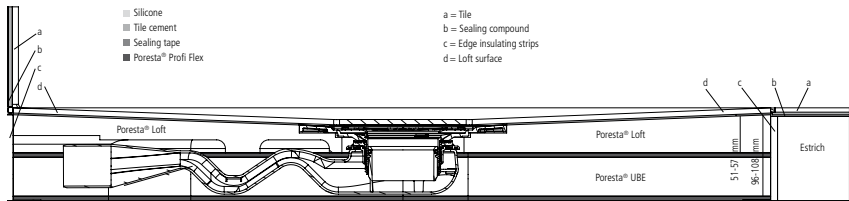

A	B	C	D	Dimensions in mm	Installation height, vertical drain		Installation height, horizontal drain	
800	800	400	400	800 x 800 x 52	52		96	
900	750	375	450	900 x 750 x 51	51		97	
900	800	400	450	900 x 800 x 51	51		98	
900	900	450	450	900 x 900 x 51	51		98	
1000	800	400	500	1000 x 800 x 52	52		98	
1000	900	450	500	1000 x 900 x 55	55		101	
1000	1000	500	500	1000 x 1000 x 55	55		101	
1100	800	400	550	1100 x 800 x 53	53		99	
1100	900	450	550	1100 x 900 x 56	56		101	
1100	1000	500	550	1100 x 1000 x 56	56		102	
1200	800	400	600	1200 x 800 x 54	54		100	
1200	900	450	600	1200 x 900 x 56	56		101	
1200	1000	500	600	1200 x 1000 x 56	56		102	
1200	1200	600	600	1200 x 1200 x 56	56		104	
1300	800	400	650	1300 x 800 x 50	50		102	
1300	900	450	650	1300 x 900 x 52	52		104	
1300	1000	500	650	1300 x 1000 x 52	52		104	
1400	800	400	700	1400 x 800 x 51	51		103	
1400	900	450	700	1400 x 900 x 52	52		104	
1400	1000	500	700	1400 x 1000 x 52	52		104	
1500	800	400	750	1500 x 800 x 55	55		104	
1500	900	450	750	1500 x 900 x 56	56		105	
1500	1000	500	750	1500 x 1000 x 57	57		105	
1600	800	400	800	1600 x 800 x 56	56		105	
1600	900	450	800	1600 x 900 x 56	56		105	
1600	1000	500	800	1600 x 1000 x 57	57		106	
1700	800	400	850	1700 x 800 x 55	55		106	
1700	900	450	850	1700 x 900 x 56	56		108	
1700	1000	500	850	1700 x 1000 x 57	57		107	
1800	800	400	900	1800 x 800 x 57	57		104	
1800	900	450	900	1800 x 900 x 56	56		108	
1800	1000	500	900	1800 x 1000 x 57	57		108	

* no adhesive needed

Dimensions in mm

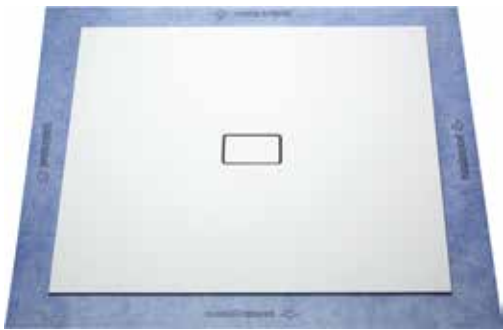
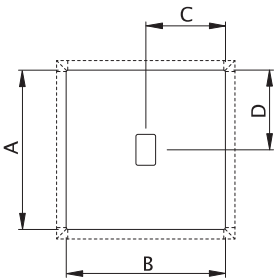

Poresta® Loft

49

Poresta® Loft S

Technical data

50

Basic data

- Floor-level shower system with linear drainage, factory prefabricated with solid white material mineral composite surface, linear mineral composite drain cover, de-centred built-in drainage unit and factory integrated sealing sleeve with pre-formed corners for waterproofing on adjoining walls/floors, with pre-formed gradients of 1.5 – 2.5%
- Low net weight
- Complete system with high-quality mineral composite surfaces, horizontal or vertical drain and circumferential sealing sleeve with horizontal drain, optional vertical drain
- Drainage capacity of horizontal outlet: 30 l/min.
- Drainage capacity of vertical outlet: 30 l/min.
- Connection in accordance with DN 50
- High stability and tread resistance due to the Poresta® support plate
- Certificated R9 slip prevention nach DIN 51130



Seal

- Shower element with factory-integrated sealing seal can be sealed at the wall and floor using Poresta® KMK sealing compound.
- gemäß der DIN 18534-1 als Einbauteil, mit flüssigem Abdichtungsstoff gemäß der DIN 18534-3 eingedichtet bis zur Wassereinwirkungsklasse W3-I
- ÖNORM B 3407: When professionally installed, complies with load classes specified in the standard up to maximum group W5



Soundproofing

- DIN 4109 / ÖNORM B 8115 / SIA 181: There are test certificates or statements from the Fraunhofer Institute for building physics on the sound levels to be achieved (water impact noise, EMPA-hammer and footfall sound insulation) when installing with Poresta® sound insulation accessories.

Barrier-free accessibility

- Accessible for wheelchairs

Accessories

- Poresta® Profi Flex
- Poresta® UBE foundation elements for height adjustment in expanded polystyrene as an alternative to a screed base
- Poresta® KMK TA outer corner, diagonally elastic, fleece-lined
- Poresta® KMK sealing compound, 2 kg containers (Plastic/mortar composite material)
- Poresta® Safety Cut 3.6 m
- Poresta® soundproofing kits



Schematic section drawing: Poresta® Loft S

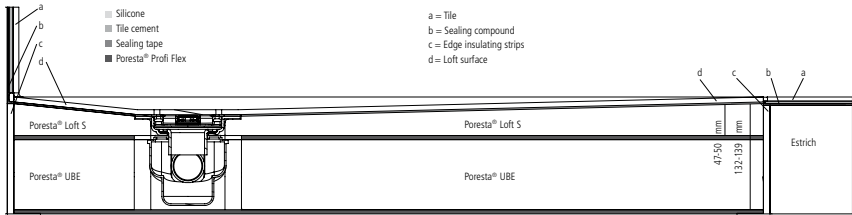

A	B	C	D	E	Dimensions in mm	Installation height, vertical drain	Installation height, horizontal drain
900	900	211	450	560	900 x 900 x 47	47	132
900	1000	211	450	560	900 x 1000 x 47	47	132
900	1100	211	450	560	900 x 1100 x 47	47	132
900	1200	211	450	560	900 x 1200 x 47	47	132
900	1300	211	450	560	900 x 1300 x 50	50	135
900	1400	211	450	560	900 x 1400 x 50	50	135
900	1500	211	450	560	900 x 1500 x 50	50	135
900	1600	211	450	560	900 x 1600 x 54	54	139
900	1700	211	450	560	900 x 1700 x 54	54	139
900	1800	211	450	560	900 x 1800 x 54	54	139
1000	1000	211	500	660	1000 x 1000 x 47	47	132
1000	1200	211	500	660	1000 x 1200 x 47	47	132
1000	1300	211	500	660	1000 x 1300 x 50	50	135
1000	1400	211	500	660	1000 x 1400 x 50	50	135
1000	1500	211	500	660	1000 x 1500 x 50	50	135
1000	1800	211	500	660	1000 x 1800 x 54	54	139
1200	1000	211	600	860	1200 x 1000 x 47	47	132
1200	1100	211	600	860	1200 x 1100 x 47	47	132
1200	1200	211	600	860	1200 x 1200 x 47	47	132
1200	1300	211	600	860	1200 x 1300 x 50	50	135
1200	1400	211	600	860	1200 x 1400 x 50	50	135
1200	1500	211	600	860	1200 x 1500 x 50	50	135

* no adhesive needed

Dimensions in mm

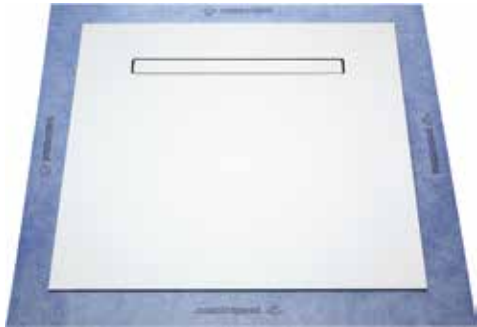
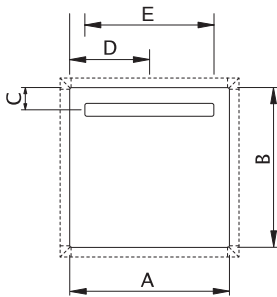

Poresta® Loft S

51

Poresta® tub installation systems

52

53

[Design options](#)
Page 54 – 59

[Technology](#)
[Poresta® bathtub](#)
[support frames](#)
Page 60 – 69

[Technology](#)
[Ferroplast® bathtub](#)
[base systems](#)
Page 70 – 79



Poresta® bathtub installation systems

A solid base for bathtubs and shower trays



- Benefits at a glance:**
- Safe and easy installation of all standard market bathtubs and shower trays
 - Masonry work no longer necessary
 - Complete system with mounting hardware
 - Faster completion of bathroom construction
 - Thermal insulation for bathwater

The Poresta® installation system for bathtubs and shower trays has been tried and tested for **rund 50 Jahren.** 

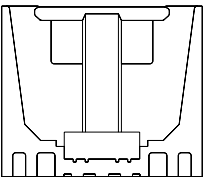
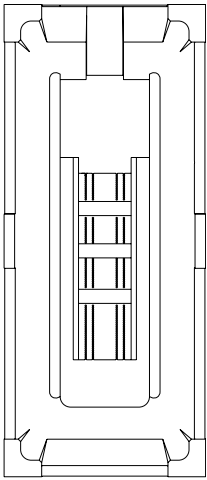

More information: Poresta® bathtub support frames, from page 61

Poresta® bathtub installation systems

Attractive, durable, safe

56



Poresta® support frames fit perfectly – which makes it easier to install even large-size bathtubs and ensures long-lasting quality in the bathroom. Individual surface designs open a new dimension for creative ideas.

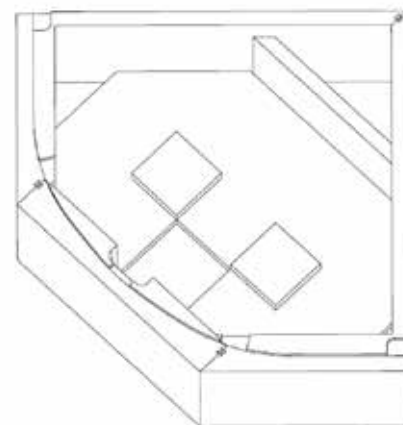

More information: [Poresta® bathtub support frames](#), from page 61



57

Poresta® bathtub installation systems

Space for creative ideas



Bathrooms can be individually created with design elements for the Poresta® bathtub support system. Steps and shelves are available in many sizes and shapes and can be adapted on-site. Along with creative accents, benefits include easier bathtub entry and exit.

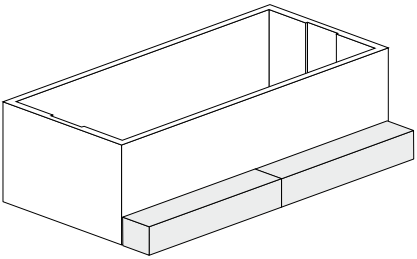

More information: Poresta® bathtub support frames, from page 61

Poresta® bathtub support frames

Product benefits

60

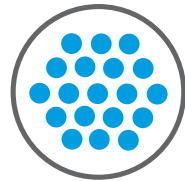

Poresta® material

Poresta® is the base material for Poresta® support frames. Poresta® is an expanded polystyrene foam (EPS) manufactured by poresta systems. For this purpose, a thermal cutting device can be used (accessory).

Variety of types

There are currently over 5,000 different bathtubs and shower trays on the market. And Poresta® bath support frames are available for each and every one. In addition to a comprehensive range of standard products, Poresta® support frames can be made to order.

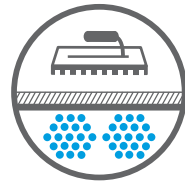

Custom tiling

The surface of the Poresta® support frames can be custom tiled directly after installation. A wide variety of designs can be created with everything from mosaic tiles to large-format natural stone.

Installation accessories

To assemble the Poresta® bath support is extensive system of accessories is available which makes installation easy and secure.

Design elements

A variety of design elements ranging from shelves and steps, to filler pieces open the door to imaginative ideas. Standard elements can be used to create bathrooms with a personal touch.



Certified soundproofing

Poresta® support frames can be combined with Poresta® soundproofing accessories. The basic and complete soundproofing sets deliver excellent sound insulation against noise from building technical systems. Results are also available for impact noise reduction. Test certificates have been issued verifying compliance with DIN 4109, VDI 4100, ÖNORM B 8115-2 and SIA 181. Complete details are outlined in the current DIN 4109, ÖNORM B 8115-2 and SIA 181 soundproofing brochures.



Fireproofing

Poresta® is a class B2 (normal flammability) building material in compliance with DIN 4102.

Poresta® shower tray support

Product range

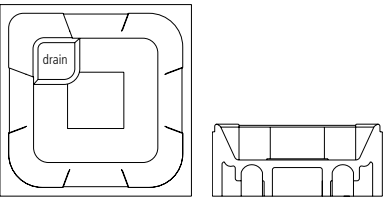

Poresta® shower tray support

- Suitable for steel shower
- 15 mm smaller in length and width than the shower tray
- Example: shower tray 900/900 mm, shower tray support 870/870 mm
- See price list for support height
- Shower tray supports in alternative heights are available on request

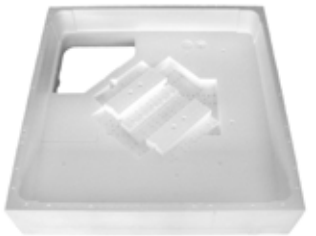

61

Floor-level shower systems

Bathtub installation systems

Poresta® bathtub support frames

Product range

62

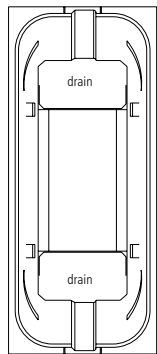

Poresta® Vario bathtub support

- For various same-size steel tub models
- A vertical and an oblique long side with two drain areas for variable installation with the angled or vertical side in the front
- 15 mm smaller in length and width than the tub
- Example: tub 1700/750 mm, support 1670/720 mm – 8° angle
- See price list for support height

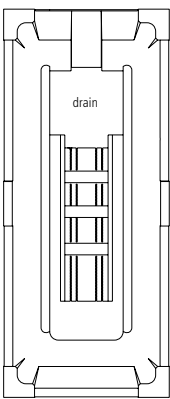

Poresta® Compact bathtub support

- Shapes: rectangle, hexagon, octagon or oval
- Custom-fit for a specific bathtub model in acrylic or steel
- Two vertical sides, flush
- Support height and outer contour depends on the bathtub shape
- Suitable for corner, octagonal, hexagonal, oval and space-saving bathtubs
- 15 mm smaller in length and width than the tub
- Example: tub 1700/750 mm, support 1670/720 mm
- See price list for support height

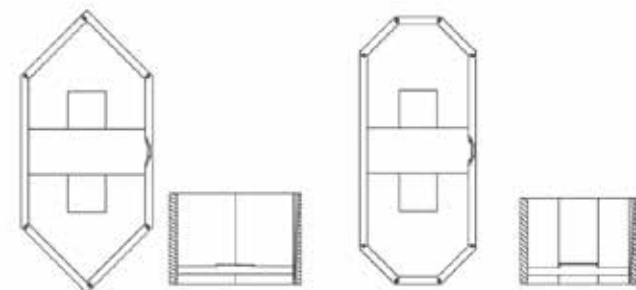

Watch installation video

63

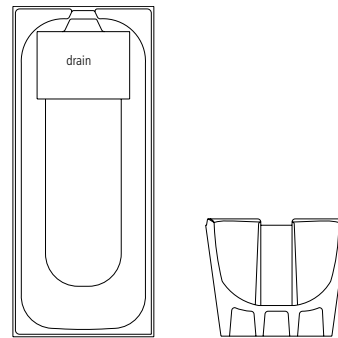

Poresta® Prosan bathtub support

- For various same-size steel tub models
- Angular shape on both long sides
- 15 mm smaller in length and width than the tub
- Example: tub 1700/750 mm, support 1670/720 mm – 8° angle
- See price list for support height

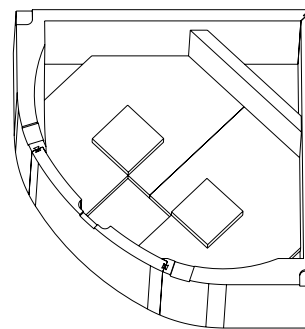

Poresta® bathtub support without shelf for corner tubs

- Flush with bathtub rim
- Suitable for corner tubs made from acrylic or steel
- Support height depends on the tub, see price list for details
- 15 mm smaller in length and width than the tub

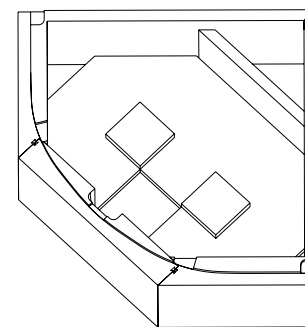

Poresta® bathtub support with shelf for corner tubs

- Support dimensions larger than tub, see price list for details
- Suitable for specific corner tubs in acrylic or steel
- Front geometry suitable for large tiles



Installing the Poresta® bathtub support

Installation

Easy installation

Installing a Poresta® support frame and bathtub is quick and easy with the right system accessories.

Installing a Poresta® support frame



First, attach the spacers with plastic pins (included).



Before tiling, the spacers can be cut to match the thickness of the tiles or wall covering material.



Apply Poresta® mounting foam to the ribbed underside of the Poresta® frame support.



Position the frame support on the floor and align it using a spirit level.



Install the Poresta® Fix drain fitting.



After cleaning the tub rim, the 3D sealing corner is attached wrinkle-free to the rim.



The rim sealing tape is then measured. The sealing tape is flush with the tub rim.



The overlap with the sealing corner is 5 cm.



The sealing strip is glued wrinkle-free to the tub rim and smoothed out with a yardstick.



To achieve optimum noise insulation, the soundproofing strip is attached around the perimeter of the tub rim.



The tub is then placed into the support.



Insert the Poresta® overflow fitting and screw it tight.



The Poresta® Fix drain insert can also be installed without opening the inspection door.



Cut out an inspection opening to test for leaks. This piece will be reinserted later.



A second strip of soundproofing strip is attached to the upper edge of the tub rim for added protection.



A 5 mm gap for the joint must be left between the outer edges of the sealing tape and the protective strip.



The rim sealing tape is attached to adjacent components with Poresta® BFA or Poresta® KMK.



The sealing compound is applied liberally to the walls. The overlap between the sealing tape and the sealing corner must be carefully coated with sealant. The sealing tape and corner are embedded in the sealant.



The 5 mm gap is also filled with sealing compound. A brush is an ideal tool for this purpose.



After the first layer is dry, the second layer of sealant is liberally and smoothly applied.



This ensures that the tub is permanently sealed.



The tiles are laid on the tub rim and the protective tape is removed.



Suitable backfill material is pressed into the joint before it is sealed with silicone.



The Poresta® bath support can be tiled immediately after installation. The bathtub should be placed under load, e.g. by filling it with water.

Excerpt from the installation instructions for the Poresta® bathtub support and Poresta® 3D bathtub sealing set. On-site installation requires the complete installation booklet.

Laying pipes



Spray the pipe with paint. Place the support frame over the freshly painted pipe to mark the position.



The spray paint is transferred to the tub support making it easier to cut out the recess.

Poresta® bath support

Design accessories

66



Shelves

Shelves used in combination with Poresta® bathtub supports are functional, attractive solutions. Standard sizes and shapes are available for many tubs and can be cut to size on site.

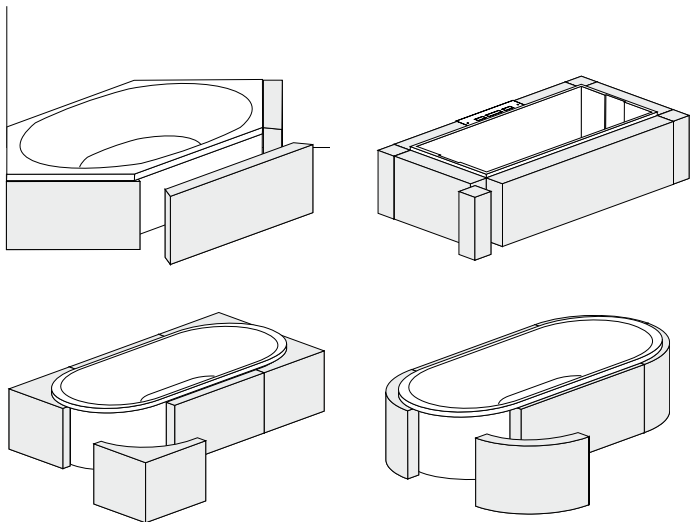

Filler pieces

Poresta® bathtub supports installed in niches often leave gaps that need to be filled. Poresta® filler pieces offer a perfect solution.

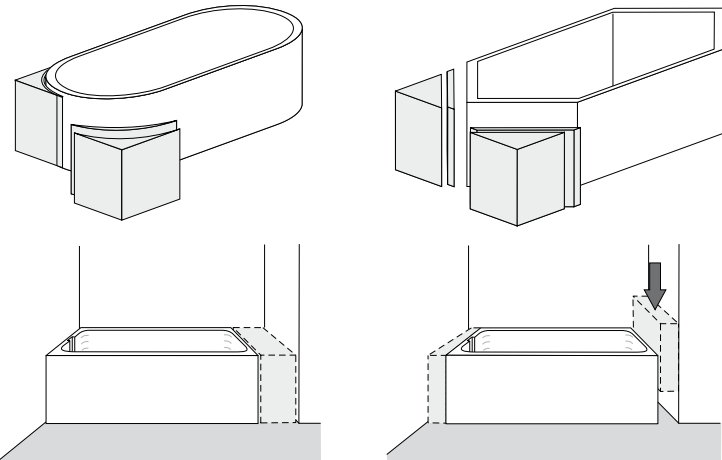

Steps

Steps can be quickly and safely installed without complex masonry work. This not only enhances bathroom design, it also makes getting into the bathtub much easier.

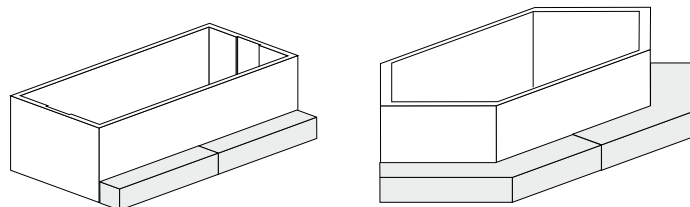

Corner modules

Poresta® corner modules offer practical solutions for installing hexagonal and octagonal tubs. Corner modules with installation systems for surface-mounted and in-wall mixers from all manufacturers are ideal for filling the space between the tub and wall. They also make it easier to install mixers. To simplify installation, the faceplate is removed and the mixer is installed in the desired position. The corner filler pieces are the same height as the tub. Corner modules extend above the rim of the tub in heights of either 305 mm or 610 mm. The corner module and filler piece are supplied as a unit.

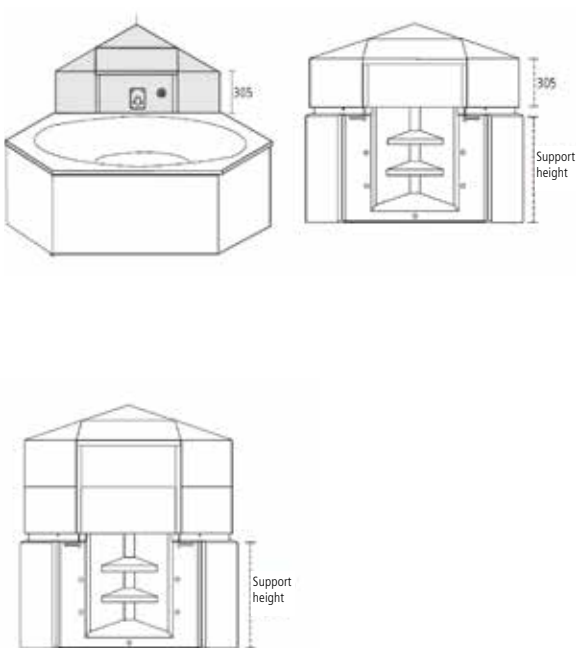

Mounting block

The mounting block is used for installation of surface-mounted or in-wall mixers when rectangular steps are used in combination with mixers installed above the tub rim.

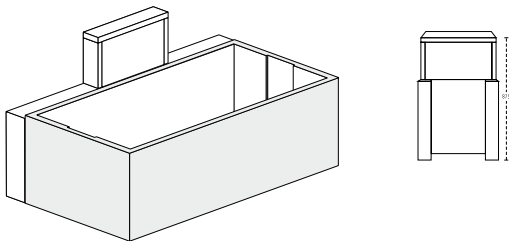

Easy installation

Installation of Poresta® corner modules/ mounting blocks is simple thanks to modular components. The modules are joined with Poresta® construction adhesive. Bathtub support frames are attached to the floor using Poresta® mounting foam.

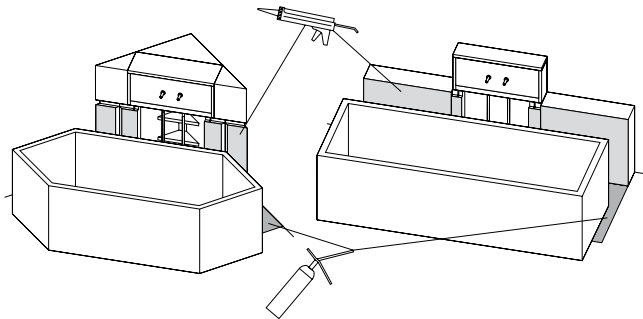

67

Poresta® bathtub support frame

Installation accessories

68



Poresta® mounting foam

Poresta® mounting foam ensures trouble-free installation of tub support frames..

- Two-component PUR mounting foam
- Compensates for uneven floors up to 15 mm
- Optimizes support frame assembly
- Dries within minutes
- VE 12 pieces, 400 ml



Poresta® STP construction adhesive (MDI-free)

- Suitable for attaching design elements to Poresta® tub supports, 310 ml
- VE 12 pieces



Poresta® Fix special accessories for bathtub and shower tray assembly

The special accessories reduce installation times by up to 80% compared to assembly with conventional drain fittings. This is because the Poresta® Fix sets are pre-installed in support frame channels.

- No fumbling through inspection door
- Pre-assembled prior to installing the bathtub
- 3-way infinitely adjustable
- Poresta® Fix Trio with integrated water input



Poresta® 3D tub rim sealing set 3.0 m

For sealing joints between wall and tubs/shower trays made from acrylic or steel. Includes:

- Transversely elastic, fleece-lined tub sealing tape (120 mm wide) with self-adhesive butyl strips, length: 3.0 m
- 3D TI sealing strip for inner tub corner (120 mm wide), fleece-lined with self-adhesive butyl strips, 1 piece
- Soundproofing strip (30 mm wide) for noise insulation, self-adhesive and fabric reinforced, length: 2 x 3.0 m
- VE 1 Set



Poresta® Safety Cut 3.6 m

To protect against damage to seals when renewing connection or maintenance joints (silicone joints). For Poresta® KMK sealing strips, 3D T bathtub rim sealing tape, 3D TI bathtub rim corner seal and 3D multi corner sealing kit. Coverage 3.6 m.

- 500 g protective components
- 500 ml liquid components
- Brush
- Stirring rod
- VE 1 set



Poresta® 3D multi corner seal set

For sealing tub rim to wall and surrounding floor (screed) with floor-level shower trays.

- Poresta® 3D multi corner seals with self-adhesive butyl strips
- Pkg. unit: 3 pieces

Planning tip: Die Poresta® 3D multi corner seals should be combined with Poresta® 3D tub sealing sets.



Poresta® SFA drain for shower tray assembly

The innovative Poresta® SFA shower tray drain is specially designed for extra-flat installation of conventional shower trays. Installation height is reduced by up to 40 mm in combination with a Poresta® shower tray support frame.

- Flow rate 42 l / min. at 15 mm accumulation height
- General construction test certificate
- Dry-out protection with second water trap chamber
- Easy to clean
- For shower trays with a drain of 90 mm
- Standard-compliant DN 50 drain connection
- Ideal for many shower tray models in combination with Poresta® shower tray supports (details on request)

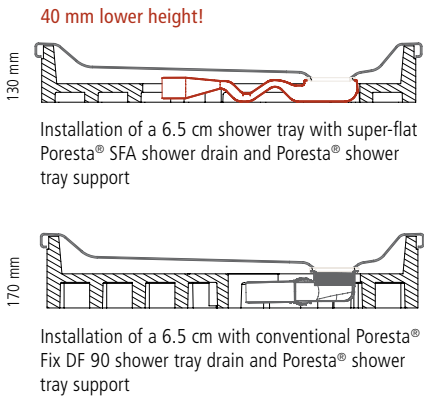

Washing machine connection

A washing machine connection integrated into the bathtub support can save centimetres of valuable space when it comes to installing a washing machine in a small bathroom.

- Clean and easy installation
- Adaptable to any interior situation
- Universal positioning of the siphon on the bathtub support

Overview of accessories

Poresta® bathtub support frame	Poresta® shower tray support frame
Poresta® mounting foam	Poresta® mounting foam
Poresta® construction adhesive	Poresta® SFA shower drain
Poresta® Fix special accessories	Poresta® Fix DF 52 and DF 90
Poresta® 3D tub rim sealing set 3.0 m	Poresta® 3D tub rim sealing set 2.0 m
Poresta® Safety Cut 3.6 m	Poresta® Safety Cut 3.6 m
Washing machine connection	Poresta® 3D multi corner seal set

69

Ferroplast® 1200 and 2000 mounting frames

The universal frame for steel or acrylic shower trays

70

Ferroplast® 1200 and 2000 mounting frames are universally suitable for steel or acrylic shower trays. Acrylic shower trays installed with a Ferroplast® frame meet the more stringent DIN 4109 sound insulation standards without additional soundproofing accessories. The beams are constructed from aluminium profiles to make the mounting frames extremely lightweight without compromising stability. **Beams can be easily trimmed to length with a handsaw.** The mounting frame is „Made in Germany“ from high-quality materials. With structural support on all sides, there is no need to anchor the shower tray to a wall.



Adjustable centre foot

Benefits Ferroplast® mounting frames:

- Universally suitable for steel or acrylic shower trays
- Standard dimensions 1200 x 1200 mm and 1200 x 2000 mm
- Can be shortened to any size
- Height-adjustable feet
- Height adjustment range from 83 mm to 160 mm
- Meets DIN 4109 sound insulation requirements without additional accessories (supplement 2, acrylic shower trays)

Technical specifications

- Mounting frame for rectangular shower trays made of steel or acrylic
- Can be shortened to any size
- 8/10 height-adjustable feet
- Centre supports designed to slide along the frame beam
- Height adjustment range from 83 mm to 160 mm
- Centre foot height adjustable with pull cord
- Aluminium profile beams can be easily trimmed to length with a handsaw
- Maximum stability thanks to high-quality, coordinated materials
- Increased noise protection meets DIN 4109, suppl. 2 standards when the mounting frame is used with an acrylic shower tray – 25 dB (A) measured on lower floor, rear of building
- Increased noise protection meets DIN 4109, suppl. 2 standards when the mounting frame is used with a steel shower tray in combination with a soundproofing kit – 25 dB (A) measured with mounting frame 1200 on lower floor, rear of building, 24 dB (A) measured with mounting frame 2000
- The mounting frame supports the shower tray on all sides, no need for anchoring in the wall
- Installation only requires standard tools and commercially available silicone
- For installing a shower tray, the mounting frame can ideally be supplemented with Poresta® 3D sealing accessories (tub edge-sealing set and multi-corner sealing set)

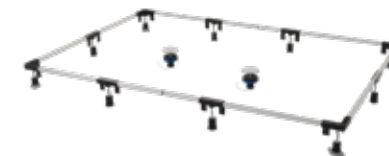

Ferroplast® 1200 mounting frame

Components:

- 4 square aluminium profiles can be easily cut to length for trouble-free resizing of the mounting frame
- 4 mounting flanges and fastening materials for attachment to floor
- 4 centre supports for the sides of the frame
- 4 corner supports for the corners of the frame
- 8 rotatable feet for adjusting frame height
- 1 height-adjustable centre foot with pull cord for supporting the centre of the shower tray
- 3 sets of threaded rods for height adjustment range 83-160 mm
- 16 fastening nuts for attaching threaded rods and adjustable feet
- 1 installation guide

Ferroplast® 2000 mounting frame

Components:

- 6 square aluminium profiles can be easily cut to length for trouble-free resizing of the mounting frame
- 2 connectors for lengthening aluminium profiles
- 4 mounting flanges and fastening materials for attachment to floor
- 6 centre supports for the sides of the frame
- 4 corner supports for the corners of the frame
- 10 rotatable feet for adjusting frame height
- 2 height-adjustable centre feet with pull cord for supporting the centre of the shower tray
- 3 sets of threaded rods for height adjustment range 83-160 mm, galvanised steel
- 20 fastening nuts for attaching threaded rods and adjustable feet
- 1 installation guide

Ferroplast® DWM soundproofing kit for steel shower trays*

Meets more stringent DIN 4109 suppl. 2 sound insulation standards.

Components:

- 2 Ferroplast® silencing mats 400 x 200 x 6.6 mm
- 10 decoupling sleeves

Adjustable centre foot

After the mounting frame and shower tray are installed, the blue cord on the centre foot can be pulled to adjust the height.

* Soundproofing kit not required with acrylic shower trays to meet DIN 4109, suppl. 2 noise insulation standards.



71

Ferroplast® bathtub base systems

Universal and robust

72 Ferroplast® bathtub base systems are available for installing acrylic or steel bathtubs. Bathtubs of different shapes and sizes can be easily installed with maximum stability.

Ferroplast® steel bathtub base



The Ferroplast® steel bathtub base is suitable for the following tub shape:

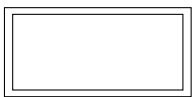

Rectangular, steel bathtubs up to 180/80 cm with a material thickness of 2.3 mm or more

- Ferroplast® bathtub base system benefits:**
- Easy installation
 - Perfectly matched mounting accessories
 - Height adjustable, rotatable feet
 - Feet can be laterally adjusted
 - High load-bearing capacity
 - Transverse centre support for maximum stability

Ferroplast® acrylic bathtub base B8 Standard, B8 XL and B8 WRA



The Ferroplast® is suitable for the following tub shapes:

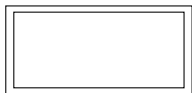

Ferroplast® B8 XL is designed for use with all rectangular acrylic bathtubs with a length of 200 cm or more.

Also available with tub rim support for heavier loads or for free-standing tubs.

B8 Standard for acrylic tubs 180 x 80 cm
B8 XL for acrylic tubs larger than 200 cm
B8 WRA for acrylic tubs that require an additional tub rim support.

Ferroplast® shower tray base systems

Extremely stable

73

Ferroplast® D5 Standard



Ferroplast® D5 is suitable for the following tub shapes:

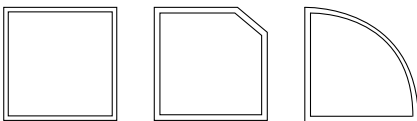

Ferroplast® D5 Mini

For super-flat shower trays in steel or acrylic up to 100 x 100 cm

Ferroplast® D5 Standard

For steel or acrylic shower trays up to 100 x 100 cm

Ferroplast® D5 Mini XL

For steel and acrylic shower trays from 75x75 to 120 x 120 cm

Ferroplast® D5 Standard XL

For steel or acrylic shower trays up to 120 x 120 cm

Ferroplast® bathtub base system benefits:

- Centre support available as a horizontal sliding carriage
- Height adjustable, rotatable feet
- Individually adjustable to tray type and size
- Easy installation
- Perfectly matched mounting accessories
- Unique: Also suitable for shower trays with centre drain (for Ferroplast® D6)
- High load-bearing capacity

Tip: For shower trays larger than 120 cm, it is advisable to use two bases if possible. Twelve feet ensure maximum shower tray stability.

The Ferroplast® D6 shower tray base system redefines the concept of stability. This system has an extra sixth foot for added strength. Ideal for installing shower trays in all shapes and sizes, Ferroplast® D6 is available in three versions: Standard, Mini and XL.

Ferroplast® D6 Standard

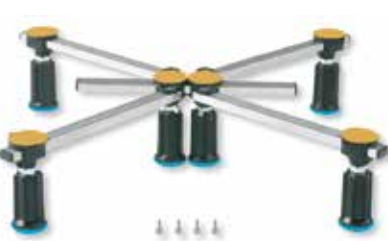

Ferroplast® D6 is suitable for the following tub shapes:

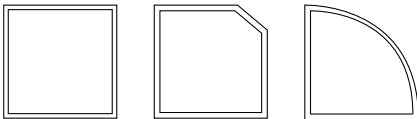

Ferroplast® D6 Mini

For super-flat shower trays in steel or acrylic up to 100 x 100 cm

Ferroplast® D6 Standard

For steel or acrylic shower trays up to 100 x 100 cm

Ferroplast® D6 Mini XL

For steel and acrylic shower trays from 75x75 to 120 x 120 cm

Ferroplast® D6 Standard XL

For steel or acrylic shower trays up to 120 x 120 cm

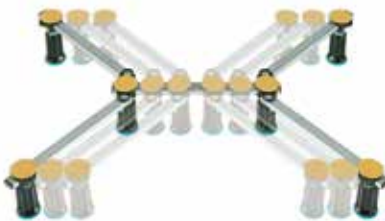

Maximum adjustment range to compensate for pipes or other obstacles beneath the tub.

Note: For tubs larger than 90x 90 cm, the following mounting accessories are required:

- Rim clamp

Ferroplast® bathtub and shower tray base systems

Installation accessories

74

A secure installation system is characterized by suitable hardware. Ferroplast® components are perfectly matched with accessories designed for installing shower trays and bathtubs in new build or renovation projects.

Ferroplast® rim clamp 3



The set consists of three rim clamps for wall attachment and support of bathtubs and shower trays.

Ferroplast® rim clamping strip



The set consists of rim clamping strips with one spring-loaded clamp and two rim clamps for wall attachment and support of bathtubs and shower trays.

Ferroplast® tub rim clamps 3 plus



The set includes two rim clamps for clamping and supporting the tub rim, one rim clamp for supporting the rim.

Ferroplast® DS 25



Adhesive tape for soundproof attachment of steel or acrylic bathtubs to a wall.

Ferroplast® SD 120



Adhesive tape for soundproof attachment of steel or acrylic bathtubs to surrounding walls.

Poresta® 3D tub rim sealing set 3,0 m



For sealing joints between wall and tubs/shower trays made from acrylic or steel.

Poresta® 3D multi corner seal set



For sealing tub rim to wall and surrounding floor (screed) with floor-level shower trays.

Ferroplast® bathtub and shower tray base systems

Quick and safe installation

Installation examples for wall attachment

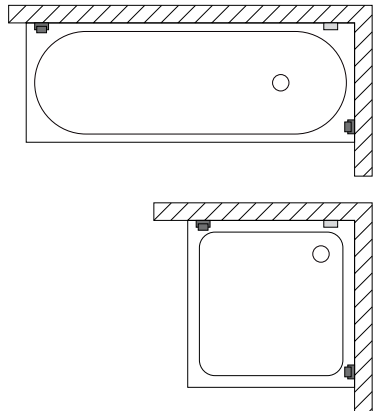
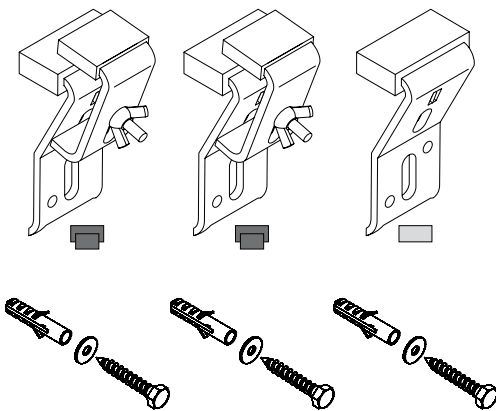

1

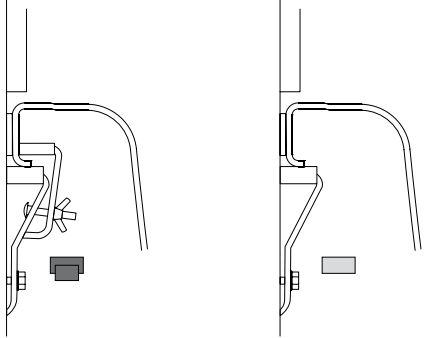

2

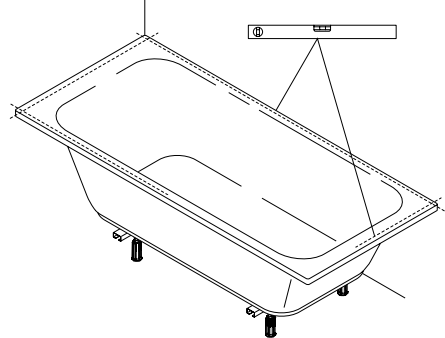

3

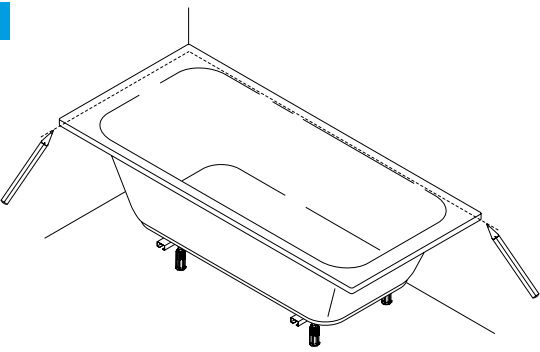

4

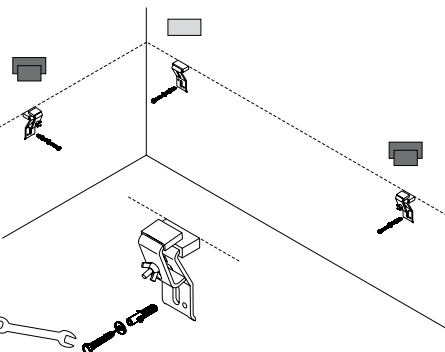

KA
K

Poresta® Universal rectangular apron

Universally applicable

76

The Poresta® Universal rectangular apron is used for ready-to-tile cladding of steel or acrylic bathtubs with a base mounting. This is especially quick in combination with Ferroplast® bathtub base systems and Poresta® mounting foam. The Poresta® Universal rectangular apron comes in a compact package – ideal for storage, transport and use at the construction site.



Poresta® Universal rectangular apron installation set „A” for corner installation of bathtubs ranging from 1600 x 600 to 1900 x 900 mm

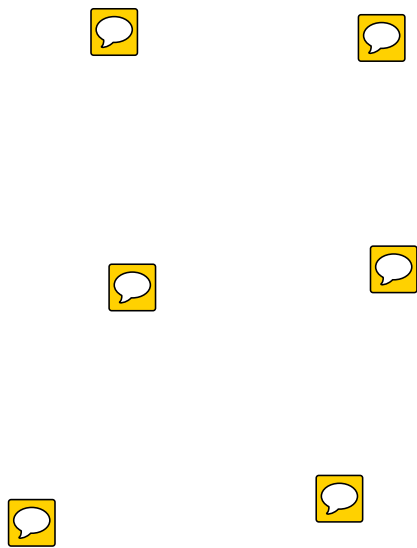

Installation accessories for a steel bathtub

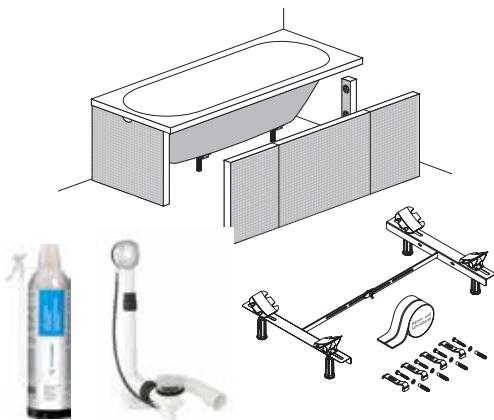

Accessories

- Poresta® Fix drain and overflow fittings
- Poresta® bathtub support mounting foam

Mounting accessories for an acrylic bathtub

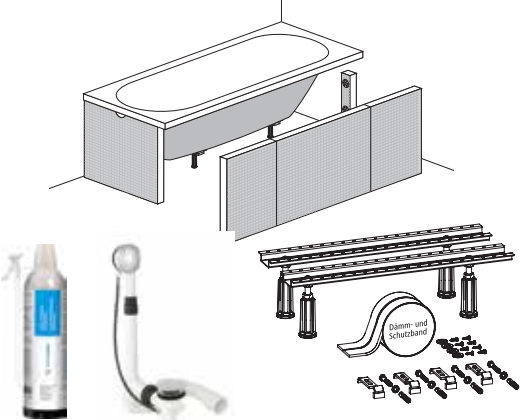

77

Ferroplast® bathtub base system and Poresta® Universal rectangular apron

Sample installation

Installing a steel bathtub

Sample installation using a Ferroplast® steel bathtub base system.



Position the base on the steel bathtub.

Remove the protective film so that the adhesive surface of base comes in full contact with the surface of the steel bathtub.

Attach and align the adjustable feet.

Measure the total distance to the upper rim.



Attach a Ferroplast® DS 25 soundproofing strip to the bathtub rim.

Installing an acrylic bathtub

Sample installation using the Ferroplast® B8 Standard.



Attach the Ferroplast® B8 Standard to the bottom of the acrylic tub.

Attach and align the adjustable feet.

Measure the total distance to the upper rim.

Attach a Ferroplast® DS 25 soundproofing strip to the bathtub rim.



Place the bathtub upright and adjust the height of the feet.

Check the alignment with a spirit level.

Installing wall brackets



The bathtub rim is either clamped, braced, or both (see page 89 for sample installation).



Use a spirit level to horizontally align the bathtub rim clamping strip and mount it to the wall with suitable fasteners.

Depending on the installation, an additional rim clamp can be attached for support.

Some installations only require one rim support.

After the wall brackets are installed, the bathtub is mounted to the clamping strip and the Ferroplast® base system feet are adjusted.

Installing the Poresta® Universal rectangular apron



The Poresta® Universal rectangular apron consists of several parts.

Assemble the parts for the long-side panel.

Trim the parts to the required length.

Wedge the apron parts into the space below the bathtub rim.



For a secure fit, insert wedges along the edge of the lower gap. Check the alignment using a spirit level.

Attach the apron parts with plastic pins (supplied).

Fill the lower gap with Poresta® installation foam.

Fill the prefabricated holes along the upper with Poresta® installation foam.



After the foam has hardened, cut off the protruding excess.

The apron can now be tiled.

This is a summary of the respective installation instructions. For installation on site, all instructions should be carefully followed step by step.

Notes

Germany

poresta systems GmbH
T +49 (0)5621.801-0
F +49 (0)5621.801-297
info-de@poresta.com

Austria

poresta systems Österreich GmbH
T +43 (0)5552.204 40 10
F +43 (0)5552.204 40 50
info-at@poresta.com

Switzerland

poresta systems ag
T +41 (0)62.216 40-44
F +41 (0)62.216 40-43
info-ch@poresta.com